



Drainage Board  
Consideration of Report Agenda

October 21, 2020, 4:30 pm

Location: <https://www.youtube.com/user/EssexOntario>

Accessible formats or communication supports are available upon request. Please contact the Clerk's Office at [clerks@essex.ca](mailto:clerks@essex.ca) or 519-776-7336 extension 1100 or 1101.

**North Rear Road Drive South Side: New Bridge for Grondin Geographic Township of Colchester North, Town of Essex, County of Essex, Project REI2020D010**

The Clerk to confirm that all notices have been sent in accordance with the Drainage Act.

Pages

**1. Call to Order**

**2. Declarations of Conflict of Interest**

**3. Adoption of Published Agenda**

**3.1. Consideration of Report Meeting Agenda for October 21, 2020**

Moved by \_\_\_\_\_

Seconded by \_\_\_\_\_

**That** the published agenda for the October 21, 202 Drainage Board be adopted as presented.

**4. Adoption of Minutes**

**4.1. Adoption of Minutes for Crystal Beach Drain held on July 9, 2020**

1

Moved by \_\_\_\_\_

Seconded by \_\_\_\_\_

**That** the minutes of the Drainage Board Meeting held July 9, 2020 be adopted as circulated.

**5. List of Written Appeals**

**6. Public Presentations**

**6.1. Gerard Rood, Professional Engineer**

10

RE: Report from Rood Engineering Incorporated dated September 24, 2020 regarding North Rear Road Drain South Side (New Bridge for Grondin), Geographic Township of Colchester North, Project REI2020D010.

Moved by \_\_\_\_\_

Seconded by \_\_\_\_\_

**That** the presentation by Gerard Rood be received and that the Report for the North Rear Road Drain South Side (New Bridge for Grondin), Geographic Township of Colchester North, Town of Essex, County of Essex, Project REI2020D010 as prepared by Gerard Rood, Professional Engineer dated September 24, 2020 be received and recommended for adoption; and

**That** it be recommended that a provisional by-law be prepared for Council's consideration; and

**That** the Report proceed to a Court of Revision to be scheduled.

**6.2. Other Public Presentations (if any)**

**7. Adjournment**

Moved by \_\_\_\_\_

Seconded by \_\_\_\_\_

**That** the meeting be adjourned at [TIME].



## Drainage Board Meeting Minutes

July 9, 2020 5:00 p.m.

**Location: Zoom Video Conferencing**

**Crystal Beach Drain: Repair and Improvement of Covered Drains**

**Geographic Township of Colchester South, Town of Essex,**

**County of Essex, Project REI2018D012**

### **1. Roll Call**

Present: Dan Boudreau  
Kirk Carter  
Percy Dufour  
Felix Weigt-Bienzle

Regrets: Luke Martin

Also Present: Kevin Girard, Director, Infrastructure Services  
Shelley Brown, Deputy Clerk  
Norm Nussio, Manager, Operations and Drainage  
Lindsay Dean, Drainage Superintendent  
Tanya Tuzlova, Operations/Drainage Clerk  
Gerard Rood, Professional Engineer, Rood Engineering Inc.

General Public: As per attached Delegation List

The Deputy Clerk confirmed that all notices have been sent in accordance with The Drainage Act.

### **2. Declarations of Conflict of Interest**

None declared.

### **3. Adoption of Published Agenda**

i) Drainage Board Meeting Agenda

Moved by Board Member Weigt-Bienzle

Seconded by Board Member Dufour

**(DB20-07-001)** That the published agenda for the July 9, 2020 Drainage Board Meeting be adopted as presented. **Carried**

**4. Adoption of Minutes**

i) Consideration of Contract Price for Shepley Drain: Replacement Bridges for Elwood Defour and Garry & Bonny Quick (Part of Lots 6 & 7, Gore Concession), Geographic Township of Colchester South, Project REI2018D024, Town of Essex, County of Essex held on June 24, 2020.

Moved by Board Member Dufour

Seconded by Board Member Weigt-Bienzle

**(DB20-07-002) That** the minutes of the Drainage Board Meeting held on June 24, 2020, be adopted as circulated. **Carried**

**5. List of Written Appeals**

Lindsay Dean, Drainage Superintendent, has informed that a letter was received by the Town from the owners of the Crystal Beach Road to review the scope of works.

**6. Public Presentations**

i) Lindsay Dean, Drainage Superintendent

Re: Crystal Beach Drain: Repair and Improvement of Covered Drains project

Lindsay Dean, Drainage Superintendent, presented the overview of the Drainage Act procedures, Crystal Beach System historic information and current concerns, pipe condition, and current project costs. Ms. Dean presented the options to proceed with this report:

- Option 1: Replace the Crystal Beach South System and Legalize future replacement of the North System
- Option 2: Complete replacement of North and South Systems.

Ms. Dean also explained the next steps for each Option and the appeal process.

ii) Other public presentations.

**Ian Wright, 134 Crystal Beach Road**

Mr. Wright asked what the price of \$15,000 represented and if it is in addition to the incurred expenses.

Lindsay Dean, Drainage Superintendent, explained that this amount is the part of incidental costs that are incorporated in the report and represents the costs spent to date for the North part of the Drain.

Mr. Wright also asked if the big trees along the drain can be kept during repairs.

Mr. Rood explained that typically contractors try to avoid damaging trees during drainage works and he does not anticipate damage to trees. Mr. Rood added that small trees located on the road allowance may be restored.

Mr. Wright asked how the residents will be able to access their properties during construction.

Mr. Rood explained that the access to the properties will be restored as quickly as possible and that access will be provided by the contractor to ensure that emergency vehicles and residents have access to their properties.

Mr. Wright advised that he prefers Option 1, to replace the South System and to legalize the future replacement of the North System.

Mr. Wright also asked if the property owners will be liable for damages to the neighbours if Option 1 is chosen.

Lindsay Dean, Drainage Superintendent, explained that the Town of Essex Solicitor has advised that the private landowners should not be exposed to liability for the property damages since the Drainage Board (Town) will make the decision regarding this project.

The Chair has asked what liability levels would be to do nothing versus choosing Options 1 or 2.

Lindsay Dean, Drainage Superintendent, explained that the liability with not completing the drainage works would be high since the Town determined that the system is out of repair. Ms. Dean added that the Town may also be liable for damages under Option 1 if the repairs are not done on the North Part of the Drainage System as this may impact the South System.

Board Member Dufour commented that the drainage system should be repaired in whole and that the needs of all residents should be taken into consideration including those not present at this meeting.

**Eric Card, 130 Crystal Beach Road**

Mr. Card stated that he feels the problem is that the sand blocks the outlet into the lake and suggested that repairs be done to the outlet on the South part of the Drain.

Mr. Rood replied that repairs to the outlet only may help reduce levels of standing water during high lake levels. Mr. Rood explained that the problem is in the overall capacity of the drainage system to carry the flows to the repaired outlet. Mr. Rood added that the whole system needs to be improved to increase drain capacity and decrease maintenance costs and advised that the whole system should be improved since this option eliminates the liability to the Town and provides the most cost effective solution.

Mr. Card commented that, in his opinion, the system is functioning well and he believes that the replacement of the whole system is not necessary.

**Barbara Ross, 104 Crystal Beach Road**

Ms. Ross expressed concern that doing partial repairs such as attaching new pipes to the old pipes of different sizes would not solve the problem and the repairs to the whole street would be necessary later.

Ms. Ross also expressed concerns regarding the standing water on the road causing odour, algae and bacteria growth.

Norm Nussio, Manager, Operations and Drainage, explained that the asphalt repairs to the road will be done to minimize that problem.

Ms. Ross concluded that she would like the job to be done right the first time.

**Jean and John Stewart, 161 Crystal Beach Road**

Mr. and Mrs. Stewart advised that they do not have any questions.

**Travis Miller, 131 Crystal Beach Road**

Mr. Miller advised that he does not have any questions.

**William Young, 136 Crystal Beach Road**

Mr. Young asked how old the original drain was.

Lindsay Dean, Drainage Superintendent, explained that the majority of the system was installed in 1968 and South System on the east side of the road and the road crossings were installed prior to that.

**Terry Hodgins, 116 Crystal Beach Road**

Mr. Hodgins commented that there was a problem with flooding on the both sides of the road for many years and asked if the system will handle it.

Mr. Rood explained the current standard design requirements to the drainage system and explained that it is designed to handle a 1 in 10 year storm event. Mr. Rood added that a larger storm capacity system would be very costly and not practical and that the proposed system will provide an adequate level of service to the adjacent lands and roads.

Mr. Hodgins asked if the system would handle the water coming in during storms.

Mr. Rood explained that the water may stand for a couple hours and then go through the outlet which will be protected from waves and sand by the baffle system. Mr. Rood advised that there are about 5-6 baffle systems along the lake in the Town of Essex and they are working well.

Mr. Hodgins asked why there is \$2,500.00 extra charge on the assessment schedule to his property.

Mr. Rood explained that special benefit assessments are for the properties with hard surface driveways or special features that need to be repaired or replaced and this charge is included as per standard OMAFRA policies.

Mr. Hodgins asked if there is a possibility to remove that cost and repair the driveways themselves.

The Chair advised that there is an option for home owners to replace their driveways themselves.

Mr. Hodgins asked if jetties could be installed on the beach.

Mr. Rood explained that this can be an environmental issue and contradict requirements from ERCA, Department of Fisheries and Oceans and other authorities to complete construction in the lake. Mr. Rood advised that jetties obstruct movement of sand on shore lines and could cause damages to the adjacent properties.

**Carol MacPherson, 105 Crystal Beach Road**

Ms. MacPherson stated that there were damages to her property caused by standing water on the driveway that would not allow her to exit her home. Ms. MacPherson also has stated that she had water in her crawl space as well as an odour she believed was coming from the catch basins.

**Mark Hernandez, 111 Crystal Beach Road**

Mr. Hernandez asked about the location of North and South Parts of the Crystal Beach Drain.

Mr. Rood explained the division of the system into North and South parts based on the map provided in the report as per the change of water direction.

Mr. Hernandez advised that he prefers Option 1.

Mr. Rood advised that work relating to Option 1 would impact municipal addresses from 137 to 142 as they are adjacent to the South System.

**Jill Kennedy, 709 County Road 50**

Ms. Kennedy stated that water covers the road when it is windy. Ms. Kennedy asked if the Town would mail out a survey, so all the residents could vote on their preferred option.

Ms. Kennedy also asked what the interest rate is and when bills will be due.

Norm Nussio, Manager of Operations and Drainage, informed that debenture terms are 5 and 10 years.

Lindsay Dean, Drainage Superintendent, advised that Finance Department will consider special requests regarding the debenture thresholds and the payment term for this project.

The Deputy Clerk advised that the interest rate would depend on the timing of the debenture and the rate may change when the work is completed.

The Chair advised that the rate is determined when the debenture is sold.

The Chair asked Board Member Dufour about the survey that was proposed by Ms. Kennedy.



Board Member Dufour replied that the surveys are usually not a part of the Drainage Act.

The Deputy Clerk advised that the survey is not a part of the Procedural By-Law.

**John Kay, 155 Crystal Beach Road**

Mr. Kay said he received a drain bill for sand removal while he was told at the last meeting that there will be no more drain bills.

Norm Nussio, Manager, Operations and Drainage, replied that the recent drain bill was for cleaning out the pipe that was completely blocked.

Mr. Kay asked what improvements he will get and if he will get a catch basin.

Mr. Rood replied that he does not see a catch basin in front of 155 Crystal Beach Road and added that the owners have the right to connect as long as it is done through the Drainage Department or the owner may ask the contractor doing the drainage works to connect and this would be the most cost effective method.

Mr. Kay asked why the catch basin was not put in front of his property and why he has to pay extra to install the catch basin.

Mr. Rood replied that he investigated and there is a slope to direct water to the next catch basin. Mr. Rood explained that he tried to keep the project cost down by providing the minimum amount of catch basins. Mr. Rood added that every property owner has the right to connect to the system themselves.

Mr. Kay asked if the connection will be provided.

The Chair clarified that Mr. Kay may ask the contractor directly to install the connection during the works.

Mr. Kay commented that Mr. Rood should have provided the catch basins for all properties.

Mr. Rood explained that he has no responsibility to extend the scope of work by providing additional features and thus increasing the cost of the project.

Mr. Rood explained that the drain was designed to divert the water and if a property owner wants a catch basin, they may connect during the project.

**Laura Hasulo, 145 Crystal beach Road**

Ms. Hasulo advised that all her questions were addressed.

**Allison Van Geest, 120 Crystal Beach Road**

Ms. Van Geest asked if this project was already approved by ERCA.

Mr. Rood replied that the report was circulated to ERCA and they provided input regarding restrictions and limitations. Mr. Rood informed that ERCA has confirmed the permit will be granted when the project is approved by Council.

Ms. Van Geest expressed concern that the changes to the drainage system will not solve the flooding problem at the end of the road because flooding is caused by high lake levels.

Mr. Rood advised that there is no control over the lake levels and by doing this project the water will be able to go back to the lake. There is no other mechanisms that could be put in place to protect against the lake levels other than raising the properties and the road and this cannot be done under the Drainage Act. The project provides for the sufficient outlet, so water can get to the open outlet at the lake.

**Tamara Deneau on behalf of Ken Chapman, 139 Crystal Beach Road**

Ms. Deneau asked if the property owners will be compensated for their properties being dug up.

Mr. Rood advised that proposed works provide for the full restoration of the properties therefore no allowances are provided. Allowances are provided only for a property in the North part of the drain since the works may affect crops.

Ms. Deneau asked how long it will take to repair the road and how much that would be.

Norm Nussio, Manager, Operations and Drainage, advised that there will not be any cost assigned to residents for road repairs.

Ms. Deneau asked why a parcel on a Crystal Beach Lane is not connected to the Drain.

Mr. Rood advised that he has reviewed the previous reports and he did not see any additional connections to the drain.

**John Kay, 155 Crystal Beach Road**

Mr. Kay asked about if those in neighbouring parcels who have beach rights would share in the cost and if the Town has authority to perform work on the lake.

Mr. Rood replied that the drainage works under the current report have the right to work across the beach since that was done in the initial report by C.G.R. Armstrong. Mr. Rood explained that the Value of Outlet charges on the assessment schedule are assessed to the property owners who have the benefit of Drainage Outlet and the charges related to the beach rights should be addressed to the Town administration.

Moved by Board Member Carter  
Seconded by Board Member Dufour

**(DB20-07-004) That** the presentation be received and that the Drainage Board’s previous resolution on Item 6 from its May 21, 2020 meeting directing that a provisional by-law be prepared for Council’s consideration and that the Report proceed to a Court of Revision for the **Crystal Beach Drain: Repair and Improvement of Covered Drains, Geographic Township of Colchester South, Town of Essex, County of Essex, Project REI2018D012** as prepared by Gerard Rood, Professional Engineer dated April 15<sup>th</sup>, 2020, be re-affirmed accordingly. **Carried**

**7. Adjournment**

Moved by Board Member Dufour  
Seconded by Board Member Weigt-Bienzle

**(DB20-07-005) That** the meeting be adjourned at 6:23 pm “Carried”.

\_\_\_\_\_  
Chair

\_\_\_\_\_  
Recording Secretary

\_\_\_\_\_  
Date

# **NORTH REAR ROAD DRAIN SOUTH SIDE**

**(New Bridge for Grondin)**

**Geographic Township of Colchester North**



**TOWN OF ESSEX**  
**33 Talbot Street South**  
**ESSEX, Ontario N8M 1A8**  
**519-776-7336**

***Rood Engineering Inc.***  
***Consulting Engineers***  
**9 Nelson Street**  
**Leamington, Ontario N8H 1G6**  
**519-322-1621**

*Project REI2020D010*  
*2020-09-24*



September 24th, 2020

Mayor and Municipal Council  
Corporation of the Town of Essex  
33 Talbot Street South  
Essex, Ontario  
N8M 1A8

Mayor Snively and Members of Council:

**NORTH REAR ROAD DRAIN SOUTH SIDE  
(New Bridge for Grondin)  
Geographic Twp. of Colchester North  
Project REI2020D010  
Town of Essex, County of Essex**

## **I. INTRODUCTION**

In accordance with the instructions received from you by letter of June 3rd, 2020, from your Town Solicitor/Clerk, Legal and Legislative Services, Robert Auger, we have prepared the following report that provides for the construction of a new farm access bridge in the North Rear Road Drain South Side. This proposed bridge is intended to provide a safe farm access for the agricultural lands owned by Gerald Grondin, in the geographic township of Colchester North. The North Rear Road Drain South Side is an open drain with a number of access bridges. The drain was constructed pursuant to the Drainage Act. A plan showing the North Rear Road Drain South Side alignment, as well as the general location of the above-mentioned bridge, is included herein as part of the report.

Our appointment and the works related to the construction of the above-mentioned farm access bridge in the North Rear Road Drain South Side, proposed under this report, is in accordance with Section 78 of the "Drainage Act, R.S.O. 1990, Chapter D.17 as amended 2010". We have performed all of the necessary survey, investigations, etcetera for the proposed bridge, as well as the North Rear Road Drain South Side, and we report thereon as follows.

## **II. BACKGROUND**

From our review of the information provided from the Town's drainage files we have established the following reports that we utilized as reference for carrying out this project:

- |    |                     |                                  |                          |
|----|---------------------|----------------------------------|--------------------------|
| 1) | December 22nd, 1967 | North Rear Road Drain South Side | C.G.R. Armstrong, P.Eng. |
| 2) | November 8th, 2004  | North Rear Road Drain South Side | Gerard Rood, P.Eng.      |

The 2004 report by Gerard Rood, P.Eng. provided for repairs to the bridge under the North Malden Road and has the latest profile for the grading of the drain. The 1967 report by C.G.R. Armstrong, P.Eng. provided for repairs and improvements to the length of the drain and was used for the 2004 report to establish the design parameters of the drain.

We arranged with the Town to provide us with the updated assessment roll information for the affected parcels. We also reviewed reports for the abutting drains and spoke to the owners to help in establishing the current watershed limit for the North Rear Road Drain South Side.

We have utilized the plans within the Rood report to establish the size parameters for the drain and the details to be used in establishing the new bridge culvert installation. We have also used this report to establish the drain profile grades, and to assist us in establishing the design grade for the subject farm access bridge installation. The Schedule of Assessment in the latest drainage report was used as a guide to establish the upstream watershed area and flows to be used in the design of the bridge.

### **III. PRELIMINARY EXAMINATION AND ON-SITE MEETING**

After reviewing all of the available drainage information and documentation provided by the Drainage Superintendent, we arranged with Town staff to schedule an online virtual on-site meeting for June 24th, 2020. The following people were in attendance at said meeting: Susie Gagnon, Gerald Grondin, Aaron Farough, Jeffrey Andrews, Felix Weigt-Bienzle, Dan Boudreau, Kirk Carter, Norm Nussio (Manager of Operations & Drainage), Tanya Tuzlova (Drainage Clerk), Lindsay Dean (Drainage Superintendent) and Gerard Rood (Rood Engineering).

Details of the proposed bridge work were reviewed. It was confirmed that the new bridge location would be set out by the owner of the parcel to allow access to the farm field for large equipment. The farm has been using the existing bridge of the residential lot that was severed.

Mr. Grondin advised us that the farm land requires a new bridge to better access the existing agricultural lands with the larger farm equipment and trucks used today. The existing bridge is too narrow, and the new bridge access will eliminate damages to the driveway and lawn area of the residential lot.

We advised the owner that the minimum standard top width for an access bridge is 6.10 metres (20 ft.) and that the bridge centreline location will need to be established with him. He was also advised that because the bridge is a new bridge, the cost of the new access bridge construction, as well as all the cost for the preparation of the Engineer's Report would be borne by him, but

future maintenance costs would be shared by the owner and upstream affected lands and roads. Any cost for additional top width will be borne by the owner. It was established that the owner prefers an 8.0 metre (24') top width. Mr. Rood asked about preferred end treatments on the proposed pipe and Mr. Grondin stated he would prefer whichever option is the most cost effective. Mr. Rood expects that the sloped end treatment will be the most cost effective and told him that the cost would be estimated for sloped ends and he would contact Mr. Grondin to discuss the details if the sloped ends were not found to be the most cost effective.

The overall drainage report procedure, future maintenance processes and grant eligibility were generally reviewed with the owners. They were also advised that the works will be subject to the approval of the Department of Fisheries and Oceans (D.F.O.), the Ministry of Natural Resources & Forestry (M.N.R.F.), Ministry of Environment, Conservation & Parks (M.E.C.P.) and the Essex Region Conservation Authority (E.R.C.A.). We further discussed bridge maintenance, sizing, and material of the proposed bridge, suggesting that a corrugated steel pipe might be employed similar to the bridges a short distance upstream and downstream.

#### **IV. FIELD SURVEY AND INVESTIGATIONS**

Following the on-site meeting we arranged for our survey crew to attend at the site and perform a topographic survey, including taking the necessary levels and details to establish the design parameters for the installation of this new access bridge.

A benchmark was looped from previous work carried out on the drain and was utilized in establishing a site benchmark near the location of the bridge. We surveyed the drain both upstream and downstream of the proposed new access bridge and picked up the existing bridges and culvert elevations in order to establish a design grade profile for the installation of the new bridge. We also took cross sections of the North Rear Road Drain South Side at the general location of the proposed bridge, as necessary for us to complete our design calculations, estimates and specifications.

The Town made initial submissions to the Essex Region Conservation Authority (E.R.C.A.) regarding their requirements or any D.F.O. requirements for the installation of the new bridge to be constructed in the North Rear Road Drain South Side. A response from the Conservation Authority was received via email on May 7th, 2020. E.R.C.A. stated that the portion of the North Rear Road Drain South Side is located within a regulated area administered by E.R.C.A. Accordingly, a permit or approval will be required by E.R.C.A. for the construction of the new bridge in the portion of the North Rear Road Drain South Side.

Former Ministry of Natural Resources & Forestry (M.N.R.F.) agreements are replaced with new legislation provisions under Ontario Regulation 242/08, Section 23.9 that is now administered by the Ministry of Environment, Conservation & Parks (M.E.C.P.), which allows repairs, maintenance, and improvements to be conducted by the Town within existing municipal drains. These works are exempt from Sections 9 and 10 of the Endangered Species Act provided that the



rules in the regulations are followed by the Town and their Contractor. When eligible, the new regulations allow Municipalities to give notice to M.N.R.F. by registering their drainage activities through an online registry system.

For the purposes of establishing the watershed area upstream of the proposed new bridge, and determining the bridge size required, we investigated and reviewed the past drainage reports on the North Rear Road Drain South Side.

## **V. FINDINGS AND RECOMMENDATIONS**

Prior to the preparation of our report, we reviewed the details of the new bridge installation including the end treatment options based on the regulatory restrictions and the cost estimates that we were to review.

Based on our detailed survey, investigations, examinations, and discussions with the affected property owner, we would recommend that a new access bridge be constructed in the North Rear Road Drain South Side at the location and to the general parameters as established in our design drawings attached herein.

During the course of our investigations, this drainage project was discussed and reviewed with E.R.C.A., to deal with any Authority issues and comments related to this Municipal drain. In the interest of fish habitat and migration, E.R.C.A. requires that the invert of any new bridge be embedded below the design or existing bottom of the drain a minimum of 10% of the bridge opening height to ensure a continued path for fish migration through the access bridge. To prevent flooding and adverse impacts upstream, the new structure needs to provide an equivalent level of service to the adjacent structures. Therefore, based on this, we have made provisions to use a corrugated steel pipe culvert as set out below, similar to the structure a short distance downstream. The North Rear Road Drain South Side is located within the Regulated Area and is under the jurisdiction of the E.R.C.A., and therefore all work has to comply with the current mitigation provisions of the E.R.C.A. Details of these mitigation measures are included in the Specifications and **Appendix “REI-A”** forming part of this report.

As part of our investigations, a D.F.O. self screening assessment of the project was carried out. The mapping indicated no species at risk or critical habitat for the area of the bridge work. In the interest of fish habitat and migration, D.F.O. requires that the invert of any new bridge be embedded below the design or existing bottom of the drain a minimum of 10% of the bridge opening height to ensure a continued path for fish migration through the access bridge. The D.F.O. Species at Risk screening maps confirm that there are no Species at Risk Fish or Mussels identified in this area. Should any species be encountered, details of required mitigation measures are included in the Specifications and **Appendix “REI-A”** forming part of this report.

As is now required under the new Endangered Species Act, 2007 Provincial Legislation administered by the Ministry of Environment, Conservation & Parks (M.E.C.P.), we have reviewed the former M.N.R.F. agreement with the Town. The M.N.R.F. mapping has basically confirmed

that there are no foreseen impacts to natural heritage features or endangered or threatened species on this project; therefore, a permit or agreement under the E.S.A. 2007 is not necessary at this time. Because turtles and snakes are mobile and snakes are indicated as sensitive in the area, we have included herein a copy of the M.N.R.F. mitigation requirements for them in **Appendix “REI-B”**.

Providing mitigation requirements are implemented it was concluded that present wildlife Species at Risk will be protected from negative impacts and will not contravene with Section 9 (species protection) or Section 10 (habitat protection) of the Endangered Species Act, 2007. Based on this information we find that the Town can proceed with the eligible new bridge construction in the drain as they are exempt under Sections 9 and 10 of the Act, provided that they follow the rules within Ontario Regulation 242/08. To address these requirements the Town has established comprehensive mitigation measures as well as species identification guides for reference. Copies of the measures and guides are available for viewing by any interested parties at the Town office.

Based on all of the above, we recommend that a new access bridge be constructed in the North Rear Road Drain South Side to serve the agricultural lands of Gerald Grondin, in accordance with this report, the attached specifications and the accompanying drawings, and that all works associated with same be carried out in accordance with Section 78 of the “Drainage Act, R.S.O. 1990, Chapter D.17 as amended 2010”.

## **VI. ESTIMATE OF COST**

Our estimate of the total cost of this work including all incidental expenses is the sum of **TWENTY FIVE THOUSAND TWO HUNDRED TWENTY FIVE DOLLARS (\$25,225.00)**, made up as follows:

### **CONSTRUCTION**

Item 1)	Provide all labour, equipment and material to construct a new access bridge consisting of 15.0 metres (49.2 ft.) of 1200mm diameter 2.0mm thick aluminized steel Type II corrugated Hel-Cor pipe with annular ends and 125mm x 25mm corrugation profile; 9 corrugation wide aluminized bolted coupler; providing sloped quarried limestone on filter cloth end protection, granular bedding, backfill, and Granular ‘A’ approach extending to the existing pavement; extend and divert tiles; excavation, compaction, silt and sediment controls, cleanup and restoration, complete.	Lump Sum	\$	16,200.00
	Net H.S.T. (1.76%)		\$	285.00
				<hr/>
<b>TOTAL FOR CONSTRUCTION</b>				<b>\$ 16,485.00</b>
				<hr/>

**INCIDENTALS**

1) Report, Estimate, and Specifications	\$ 2,000.00
2) Survey, Assistants, Expenses, Drawings, Duplication Cost of Report and Drawings, Consideration Meeting, etc.	\$ 4,000.00
3) Estimated Cost of Preparing Tender Documents	\$ 500.00
4) Estimated Cost of Construction Supervision and Inspection (based on 1 days)	\$ 1,000.00
5) Net H.S.T. on Items Above (1.76%)	\$ 132.00
6) Estimated Cost of E.R.C.A. permit	\$ 500.00
7) Estimated Contingency Allowance	\$ 608.00
	<hr/>
<b>TOTAL FOR INCIDENTALS</b>	<b>\$ 8,740.00</b>
<b>TOTAL FOR CONSTRUCTION (brought forward)</b>	<b>\$ 16,485.00</b>
	<hr/>
<b>TOTAL ESTIMATE</b>	<b>\$ 25,225.00</b>
	<hr/>

**VII. DRAWINGS AND SPECIFICATIONS**

As part of this report, we have attached design drawings for the construction of this new access bridge. The design drawings show the subject bridge location and the details of the new access bridge installation. The design drawings are attached to the back of this report and are labelled **Appendix “REI-E”**.

Also attached, we have prepared Specifications which set out the required construction details for the proposed bridge installation, which also includes Standard Specifications within **Appendix “REI-C”**.

### **VIII. SCHEDULE OF ASSESSMENT**

We would recommend that all of the costs associated with the construction of this new access bridge, and the preparation of this Engineer's report, be assessed against the agricultural lands of Gerald Grondin in the Town of Essex. A Schedule of Assessment has been prepared and included herein to indicate the lands assessed for this new farm access bridge installation.

It has been clearly established that this new access bridge is being provided to serve as the access from North Malden Road to an existing agricultural farm parcel. Pursuant to the current Agricultural Drainage Infrastructure Program (A.D.I.P.) Policies that are in place, it is anticipated that these lands designated as Farm Property Tax Class will not be eligible for a grant from the Ontario Ministry of Agriculture, Food and Rural Affairs (O.M.A.F.R.A.) in the amount of 1/3 of their total assessment for this project as the severance was made earlier this year that caused the need for the new access bridge, and not prior to August 2004 as per the Policies.

Where a bridge structure has increased top width beyond the standard 6.10 metre (20.0 ft.) top width, all of the increased costs resulting from same are assessed 100% to the Owner, as provided for in the cost sharing set out in the report below.

### **IX. FUTURE MAINTENANCE**

We recommend that the bridge structure as identified herein, be maintained in the future as part of the drainage works. We would also recommend that the bridge, for which the maintenance costs are to be shared with the upstream lands and roads within the watershed, be maintained by the Town and that said maintenance would include works to the bridge culvert, bedding, backfill and end treatment. Should concrete, asphalt, or other decorative driveway surfaces over these bridge culverts require removal as part of the maintenance works, these surfaces shall also be repaired or replaced as part of the works. Likewise, if any fencing, gate, decorative walls, guardrails, or other special features exist that will be impacted by the maintenance work, they are also to be removed and restored or replaced as part of the bridge maintenance work. However, the cost of the supply and installation of any surface materials other than Granular "A" material and the cost of removal and restoration or replacement, if necessary, of any special features, shall be totally assessed to the benefiting adjoining Owner(s) served by said access bridge.

After the completion of all of the works included within this report, the access bridge within the Drain shall be maintained in the future by the Town of Essex. Furthermore, if any maintenance work is required to this access bridge in the future, we recommend that 63.5% of the future maintenance costs shall be assessed as a Benefit against the abutting agricultural property being served by the access bridge, which is currently owned by Gerald Grondin, and the remaining balance of 36.5% be assessed pro-rata against the upstream lands and roads based on their Outlet Liability assessment in the 1967 C.G.R. Armstrong report Schedule of Assessment or any future updated Schedule of Assessment for the drain. This sharing reflects that the owner has requested a bridge with 8.0 metre (24 feet) top width that is normally shared with 6.1 metres

standard bridge top width between the owner and upstream affected lands and roads, and the cost of the extra width to the bridge owner.

The above provisions for the future maintenance of this new access bridge, being constructed under this report, shall remain as aforesaid until otherwise determined under the provisions of the "Drainage Act, R.S.O. 1990, Chapter D.17 as amended 2010".

All of which is respectfully submitted.

***Rood Engineering Inc.***



Gerard Rood, P.Eng.



tm

att.

**ROOD ENGINEERING INC.**

Consulting Engineers  
9 Nelson Street  
LEAMINGTON, Ontario N8H 1G6

**SCHEDULE OF ASSESSMENT**  
**NORTH REAR ROAD DRAIN SOUTH SIDE**  
**Town of Essex**

**5. PRIVATELY OWNED - AGRICULTURAL LANDS (non-grantable):**

<u>Tax Roll</u> <u>No.</u>	<u>Con.</u> <u>or</u> <u>Plan</u> <u>No.</u>	<u>Lot or Part</u> <u>of Lot</u>	<u>Acres</u> <u>Owned</u>	<u>Acres</u> <u>Afft'd</u>	<u>Hectares</u> <u>Afft'd</u>	<u>Owner's Name</u>	<u>Value of</u> <u>Benefit</u>	<u>Value of</u> <u>Outlet</u>	<u>TOTAL</u> <u>VALUE</u>
520-02300	N.M.R.	Pt. Lot 7	20.488	15.00	6.070	Gerald Grondin	\$ 16,018.00	\$ 9,207.00	\$ 25,225.00
<b>Total on Privately Owned - Agricultural Lands (non-grantable).....</b>							<b>\$ 16,018.00</b>	<b>\$ 9,207.00</b>	<b>\$ 25,225.00</b>
<b>TOTAL ASSESSMENT</b>				15.00	6.07		<b>\$ 16,018.00</b>	<b>\$ 9,207.00</b>	<b>\$ 25,225.00</b>
=====									

1 Hectare = 2.471 Acres  
Project No.REI2020D010  
September 24th, 2020



**SPECIFICATIONS****NORTH REAR ROAD DRAIN SOUTH SIDE****New Bridge for Grondin****(Geographic Township of Colchester North)****TOWN OF ESSEX****I. GENERAL SCOPE OF WORK**

The North Rear Road Drain South Side currently comprises of an open Municipal drain with a number of access bridges generally located along the south side of North Malden Road and extending from its outlet into King Creek to its upper end near Brush Road. The work under this project generally comprises of construction of a new access bridge serving the agricultural lands of Grondin. The work on the new bridge being constructed includes the installation of a new culvert to the west of the existing bridge at MN 3343 North Malden Road; new culvert end treatments comprising of sloped quarried limestone on filter cloth end protection; granular approaches and backfill; and granular transition areas; along with ancillary work.

All work shall be carried out in accordance with these specifications, the plans forming part of this drainage project, as well as the Standard Details included in **Appendix "REI-C"**. The bridge new construction shall be of the size, type, depth, etcetera, as is shown in the accompanying drawings, as determined from the Benchmarks, and as may be further laid out at the site at the time of construction. All work carried out under this project shall be completed to the full satisfaction of the Town Drainage Superintendent and the Consulting Engineer.

**II. E.R.C.A. AND D.F.O. CONSIDERATIONS**

The Contractor will be required to implement stringent erosion and sedimentation controls during the course of the work to help minimize the amount of silt and sediment being carried downstream into the King Creek Drain. It is intended that work on this project be carried out during relatively dry weather to ensure proper site and drain conditions and to avoid conflicts with sediment being deposited into the outlet drainage system. All disturbed areas shall be restored as quickly as possible with grass seeding and mulching installed to ensure a protective cover and to minimize any erosion from the work sites subsequent to construction. The Contractor may be required to provide temporary silt fencing and straw bales as outlined further in these specifications.



All of the work shall be carried out in accordance with any permits or authorizations issued by the Essex Region Conservation Authority (E.R.C.A.) or the Department of Fisheries and Oceans (D.F.O.), copies of which will be provided, if available, and the notes in **Appendix “REI-A”**. The Contractor is advised that no work may be carried out in the existing drain from March 15th to June 30th of any given year because the drain is directly connected to a downstream area that is classified as sensitive to impacts on aquatic life and habitat by E.R.C.A. and D.F.O.

As part of its work, the Contractor will implement the following measures that will ensure that any potential adverse effects on fish and fish habitat will be mitigated:

- a) As per standard requirements, work will not be conducted at times when flows in the drain are elevated due to local rain events, storms, or seasonal floods. Work will be done in the dry.
- b) All disturbed soils on the drain banks and within the channel, including spoil, must be stabilized immediately upon completion of work. The restoration of the site must be completed to a like or better condition to what existed prior to the works. The spoil material must be hauled away and disposed of at a suitable site, or spread an appropriate distance from the top of the drain bank to ensure that it is not washed back into the drain.
- c) To prevent sediment entry into the Drain, in the event of an unexpected rainfall, silt barriers and/or traps must be placed in the channel during the works and until the site has been stabilized. All sediment and erosion control measures are to be in accordance with related Ontario Provincial Standards. It is incumbent on the proponent and their Contractors to ensure that sediment and erosion control measures are functioning properly and are maintained and upgraded as required.
- d) Silt or sand accumulated in the barrier traps must be removed and stabilized on land once the site is stabilized.
- e) All activities including maintenance procedures should be controlled to prevent the entry of petroleum products, debris, rubble, concrete, or other deleterious substances into the water. Vehicular refuelling and maintenance should be conducted away from the water.

### **III. M.N.R.F. - M.E.C.P. CONSIDERATIONS**

The Contractor is to note that the Ministry of Natural Resources and Forestry (M.N.R.F.) screening process by way of a Species at Risk (S.A.R.) review of the M.N.R.F. “Endangered Species Act, 2007” (E.S.A.) that is administered by the Ministry of Environment, Conservation and Parks (M.E.C.P.) will be completed as a self-assessment by the Town pursuant to Section 23.9 of the E.S.A. prior to construction. This Section allows the Town to conduct eligible works of repair, maintenance, and improvement to existing municipal drains under the Drainage Act, and exemptions from Sections 9 and 10 of the E.S.A., provided that the requirements are followed in accordance with Ontario Regulation 242/08. The results of the review will be provided to the Contractor and copies

of the mitigation measures, habitat protection and identification sheets will be included within **Appendix “REI-B”**.

The Contractor is to review **Appendix “REI-B”** in detail and is required to comply in all regards with the contents of said M.N.R.F. – M.E.C.P. measures, and follow the special requirements therein included during construction. Throughout the course of construction, the Contractor will be responsible to ensure that all necessary provisions are undertaken to protect all species at risk and their habitats. If a threatened or sensitive species is encountered, the Contractor shall notify the Town and M.N.R.F. – M.E.C.P. and provide all the equipment and materials stipulated by the mitigation requirements for handling the species and cooperate fully with the Town and M.N.R.F. – M.E.C.P. staff in the handling of the species.

#### **IV. ACCESS TO WORK**

The Contractor is advised that the majority of the work to be carried out on this project extends along the south side of North Malden Road. The Contractor shall have access for the full width of the roadway abutting the proposed drainage works. The Contractor may utilize the right-of-way as necessary, to permit the completion of all of the work required to be carried out for this project. The Contractor shall also have access into the driveways as necessary to construct the new access bridge, as set out on the plans and in these specifications, along with a sufficient area in the vicinity of the bridge to carry out the required construction of the new structure installation and ancillary work.

The Contractor shall ensure that the traveling public is protected at all times while utilizing the roadway for its access. The Contractor shall provide traffic control, including flag persons when required. Should the Contractor have to close North Malden Road for the proposed works, it shall obtain the permission of the Town Drainage Superintendent or Consulting Engineer and arrange to provide the necessary notification of detours around the site. The Contractor shall also ensure that all emergency services, school bus companies, etcetera are contacted about the disruption to access at least 48 hours in advance of same. All detour routes shall be established in consultation with the Essex Works Department.

Due to the extent of the work and the area for carrying out the work, the Contractor will be required to carry out all of the necessary steps to direct traffic and provide temporary diversion of traffic around work sites, including provision of all lights, signs, flag persons, and barricades required to protect the safety of the traveling public. Any accesses or areas used in carrying out the works are to be fully restored to their original conditions by the Contractor at its cost, including topsoil placement and lawn restoration as directed by the Town Drainage Superintendent and the Consulting Engineer. Restoration shall include but not be limited to all necessary levelling, grading, shaping, topsoil, seeding, mulching, and granular placement required to make good any damage caused.

## **V. REMOVAL OF BRUSH, TREES AND RUBBISH**

Where there is any brush, trees or rubbish along the course of the drainage works, including the full width of the work access, all such brush, trees or rubbish shall be close cut and grubbed out, and the whole shall be chipped up for recycling, burned or otherwise satisfactorily disposed of by the Contractor. The brush and trees removed along the course of the work are to be put into piles by the Contractor in locations where they can be safely chipped and disposed of, or burned by it, or hauled away and disposed of by the Contractor to a site to be obtained by it at its expense. Prior to and during the course of any burning operations, the Contractor shall comply with the guidelines prepared by the Air Quality Branch of the Ontario Ministry of the Environment; and shall ensure that the Environmental Protection Act is not violated. The Contractor will be required to notify the local fire authorities to obtain any permits and co-operate with them in the carrying out of any work. The removal of brush and trees shall be carried out in close consultation with the Town Drainage Superintendent or Consulting Engineer to ensure that no decorative trees or shrubs are disturbed by the operations of the Contractor that can be saved. It is the intent of this project to save as many trees and bushes as practical within the roadway allowances and on private lands. Where decorative trees or shrubs are located directly over drainage pipes, the Contractor shall carefully extract same and turn them over to the Owner when requested to do so and shall cooperate with the Owner in the reinstallation of same if required.

Following the completion of the work, the Contractor is to trim up any broken or damaged limbs on trees which are to remain standing, and it shall dispose of said branches along with other brush, thus leaving the trees in a neat and tidy condition.

## **VI. DETAILS OF BRIDGE WORK**

The Contractor shall provide all material, labour, and equipment to construct a new access bridge in the North Rear Road Drain South Side requiring work, along with endwall installation and ancillary work.

The new access bridge installation shall comprise 1200mm diameter aluminized steel Type II helical pipe with 125mm X 25mm corrugations. All piping sections shall be connected by the use of 9 corrugation (9-C) bolted couplers installed around the complete circumference of the pipe in accordance with the manufacturer's recommendation. Each coupler shall be wrapped in filter cloth material around the complete circumference to ensure that there will be no soil migration through the joints and into the pipe through said connections.

The new pipe installation on this project shall be set to the grades as shown on the plans or as otherwise established herein and the Town Drainage Superintendent or the Consulting Engineer may make minor changes to the bridge alignment as they deem necessary to suit the site conditions. All work shall be carried out in general accordance with the items in the **"STANDARD**

**SPECIFICATIONS FOR ACCESS BRIDGE CONSTRUCTION** attached to this report and labelled **Appendix “REI-C”**.

## **VII. CORRUGATED STEEL PIPE INSTALLATION**

The new corrugated steel pipe (C.S.P.) to be installed on this project is required to be provided in the longest lengths that are available and shall not be less than 3.0 metres. Where the overall access pipe length exceeds the standard pipe lengths, the Contractor shall connect the pipe sections together by use of a manufactured 9-C bolted coupler installed in accordance with the manufacturer’s recommendations. All coupler joints shall be wrapped with a layer of filter cloth around the complete circumference so that it extends a minimum of 100mm beyond the coupler on each end, to ensure a positive seal against soil migration through the joints.

The Contractor shall note that the placement of any new culvert pipe shall be performed totally in the dry and it shall be prepared to take whatever steps are necessary to ensure same, all to the full satisfaction of the Town Drainage Superintendent or the Consulting Engineer. As part of the work, the Contractor will be required to clean out the drain along the full length of the pipe and for a distance of 3.05 metres (10 ft.) upstream and downstream of the pipe. The Contractor shall note that the pipe inverts are set at least 10% of the pipe diameter (or the pipe rise) below the drain bottom to provide the embedment required by E.R.C.A. and D.F.O. and to meet the minimum cover requirements for the pipe.

The installation of the complete length of the new culvert pipe, including all appurtenances, shall be completely inspected by the Town Drainage Superintendent or the Consulting Engineer’s Inspector prior to backfilling any portions of same. Under no circumstance shall the Contractor commence the construction or backfill of the new culvert pipe without the site presence of the Town Drainage Superintendent or the Consulting Engineer’s Inspector to inspect and approve said installation. The Contractor shall provide a minimum of two (2) working days’ notice to the Town Drainage Superintendent or the Consulting Engineer prior to commencement of the work. The installation of the new culvert structure is to be performed during normal working hours of the Town Drainage Superintendent and the Consulting Engineer from Monday to Friday unless written authorization is provided by them to amend said working hours.

For the access bridge installation, once the new aluminized steel type II corrugated pipe has been satisfactorily set in place, the Contractor shall completely backfill same with granular material M.T.O. Type “B” O.P.S.S. Form 1010 with the following exception. The top 305mm (12”) of the backfill material for the full top width of the access, and the full top width of the drain or the excavated trench, and any approaches to the north and transitions to the south shall be granular material M.T.O. Type “A” O.P.S.S. Form 1010. All of the driveway approach areas extending from the Town roadway to the south top of bank of the drain and shall be backfilled with compacted granular material M.T.O. Type “A” O.P.S.S. Form 1010, but only after all topsoil material has been completely removed and disposed of, and the minimum thickness of this granular material shall be 305mm (12”). All areas outside of the access driveway shall be backfilled with native material

compacted to 96% of Standard Proctor Density and topped with a minimum of 50mm of topsoil and shall be seeded and mulched.

The Contractor shall at all times be very careful when performing its backfilling and compaction operations so that no damage is caused to the pipe. To ensure that no damage is caused to the proposed pipe, alternative methods of achieving the required backfill compaction shall be submitted to the Consulting Engineer or the Town Drainage Superintendent for their approval prior to the commencement of this work.

The Contractor will be responsible to restore any damage caused to the roadways at its cost. All damaged hard surface roadway areas shall be neatly saw cut and the damaged materials removed and disposed of by the Contractor prior to carrying out any restoration work. The extent of the repairs shall be established in consultation with the Town Drainage Superintendent, the Road Authority, and the Consulting Engineer and the repairs shall be completed to their full satisfaction.

The Contractor is to note that any intercepted pipes or tiles along the length of the proposed new culvert are to be extended and connected at its cost to the open drain at the end of the new culvert unless otherwise noted in the accompanying drawings.

The Contractor shall also note that the placing of the new access bridge culvert shall be completed so that it totally complies with the parameters established and noted in the Bridge Details and Tables for the culvert replacement. The culvert shall be set on an even grade and the placement shall be performed totally in the dry, and the Contractor should be prepared to take whatever steps are necessary to ensure same, all to the full satisfaction of the Town Drainage Superintendent or the Consulting Engineer. The Contractor shall also be required to supply a minimum of 100mm (4") of 20mm (3/4") clear stone bedding underneath the culvert pipe extending from the bottom of the drain to the culvert invert grade, all to the full satisfaction of the Town Drainage Superintendent or the Consulting Engineer. Furthermore, if an unsound base is encountered, it must be removed and replaced with 20mm (3/4") clear stone satisfactorily compacted in place to the full satisfaction of the Town Drainage Superintendent or the Consulting Engineer. The Contractor is to note that when placing an access bridge culvert, it shall be required to excavate a trench having a width not less than the new pipe outside diameter plus a 600mm working width on both sides of the new pipe to allow for proper installation of granular backfill and compaction of same. The Contractor shall also note that all culvert pipe installations are to be carried out with a minimum of 10% of their diameter or rise embedded below the drain design bottom, as shown, and noted on the plan for the access bridge installation.

## **VIII. REMOVALS**

All unsuitable and deleterious materials from the excavation of the drain cleaning shall be hauled away and disposed of by the Contractor to a site to be obtained by it at its expense. Likewise, any material excavated to allow for the granular approaches to the bridge, driveway transitions, or installation of new headwalls shall also be hauled away and disposed of by the Contractor.

**IX. CONCRETE FILLED JUTE BAG, PRECAST CONCRETE BLOCK OR SLOPED END PROTECTION**

Unless otherwise shown or noted, the Contractor is to provide new concrete filled jute bag headwalls, precast concrete block, or sloped quarried limestone on non-woven filter cloth end protection for the access bridge being constructed in this drain.

The concrete filled jute bags are to be provided and laid out as is shown and detailed in the drawings provided by the Town and as noted in the Standard Specifications in **Appendix "REI-C"**. In all cases, the concrete filled jute bag headwalls shall be topped with a minimum 100mm (4") thick continuous concrete cap comprising 30MPa concrete with 6%  $\pm$ 1% air entrainment for the entire length of the headwalls. The headwalls shall be installed on an inward batter to be not less than 1 horizontal to 5 vertical, and under no circumstances shall this batter, which is measured from the top of the headwall to the projection of the end of the pipe, be less than 305mm (12"). From the midpoint of the pipe height down to the concrete footing, the wall shall be a double concrete filled jute bag installation. On the roadside the walls shall be deflected as shown to provide daylighting and a better approach across the new bridge.

The installation of the concrete filled jute bag headwalls, unless otherwise specified, shall be provided in total compliance with the Items 1, 3, and 4 included in the **"STANDARD SPECIFICATIONS FOR ACCESS BRIDGE CONSTRUCTION"**. These are attached to the back of these specifications and labelled **Appendix "REI-C"**. The Contractor shall comply in all respects with the General Conditions included in Item 4 and the **"Typical Concrete Filled Jute Bag Headwall End Protection"** detail also shown therein.

The Contractor shall install interlocking precast concrete blocks with filter cloth backing for walls on both ends of the bridges requiring same. The blocks shall be minimum 600X600X1200mm in size as available from Underground Specialties - Wolseley, Windsor, Ontario, or equal, and installed as set out in **Appendix "REI-C"**. Vertical joints shall be staggered by use of half blocks where needed and wingwall deflections when required shall employ 45-degree angled blocks. Voids between the blocks and the pipe shall be grouted with 30MPa concrete having 6%  $\pm$ 1% air entrainment and extend for the full thickness of the wall and have a smooth uniform finish on the face that blends with the precast blocks. The installation of the endwalls, as well as the backfilling of the pipe where applicable, shall be provided in compliance with Items 1), 3), and 4) of the "Standard Specifications for Access Bridge Construction" attached within **Appendix "REI-C"** and in total compliance and in all respects with the General Conditions included in said Appendix. The Contractor shall submit shop drawings for approval of the wall installation that includes details for a minimum 300mm thick concrete footing that extends from the pipe invert downward. The footing shall extend into the drain banks each side for the required embedment of the blocks and be constructed to ensure that the completed wall will be completely vertical or tipped slightly back towards the driveway. Where the block walls extend more than 1.8 metres in height, the supplier shall provide the Contractor with uni-axial geogrid (SG350 or equivalent) reinforcement for installation to tie the wall back into the granular backfill. The Contractor, in all

cases, shall comply with these specifications and upon completion of the stacked precast concrete end protection installation shall restore the adjacent areas to their original conditions. The Contractor shall supply quarried limestone on filter cloth rock protection adjacent to the headwalls at each corner of the bridge. All rock protection shall be 1.0 metres wide and 305mm (12") thick, installed on non-woven filter cloth, and shall be installed in accordance with Item 2) of the "Standard Specifications for Access Bridge Construction". The synthetic filter mat to be used shall be non-woven geotextile GMN160 conforming to O.P.S.S. 1860 Class I, as available from Armtec Construction Products through Underground Specialties - Wolseley in Windsor, Ontario or equal. The quarried limestone to be used shall be graded in size from a minimum of 100mm to a maximum of 250mm, and is available from Walker Industries Amherst Quarries, in Amherstburg, Ontario, or equal.

Where sloped end protection is specified, the top 305mm (12") of backfill material over the ends of the access pipe, from the invert of said pipe to the top of the driveway elevation of the access bridge or enclosure, shall be quarried limestone. The quarried limestone shall be provided as shown and detailed on the plans or as indicated in the Standard Specifications in **Appendix "REI-C"** and shall be graded in size from a minimum of 100mm (4") to a maximum of 250mm (10"). The quarried limestone to be placed on the sloped ends of an access bridge or enclosure shall be underlain with a synthetic **non-woven** geotextile filter fabric. The sloped quarried limestone protection is to be rounded as shown on the plan details and shall also extend along the drain side slopes to a point directly in line with the ends of the culvert pipe. The roadside approach to the entrance shall be provided with a minimum 5.0m radius at each end of the driveway entrance. All work shall be completed to the full satisfaction of the Town Drainage Superintendent or the Consulting Engineer.

The installation of the sloped quarried limestone end protection, unless otherwise specified herein, shall be provided in total compliance with Item 2), 3), and 4) of the **"STANDARD SPECIFICATIONS FOR ACCESS BRIDGE CONSTRUCTION"**. These are attached to the back of these specifications and labelled **Appendix "REI-C"**. The Contractor shall comply in all respects with the General Conditions included in Item 4 and the **"Typical Quarried Limestone End Protection Detail"** also in **Appendix "REI-C"**.

The quarried limestone erosion protection shall be embedded into the sideslopes of the drain a minimum thickness of 305mm and shall be underlain in all cases with non-woven synthetic filter mat. The filter mat shall not only be laid along the flat portion of the erosion protection, but also contoured to the exterior limits of the quarried limestone and the unprotected slope. The width of the erosion protection shall be as established in the accompanying drawings or as otherwise directed by the Town Drainage Superintendent or the Consulting Engineer during construction. In placing the erosion protection, the Contractor shall carefully tamp the quarried limestone pieces into place with the use of the excavator bucket so that the erosion protection when completed will be consistent, uniform and tightly laid. In no instance shall the quarried limestone protrude beyond the exterior contour of the unprotected drain sideslopes along either side of said protection. The synthetic filter mat fabric to be used shall be non-woven geotextile GMN160 conforming to O.P.S.S. 1860 Class I, as available from Armtec Construction Products, or equal.

The quarried limestone to be used shall be graded in size from a minimum of 100mm to a maximum of 250mm, and is available from Walker Aggregates Amherst Quarries, in Amherstburg, Ontario, or equal.

#### **X. BENCHMARKS**

Also, for use by the Contractor, we have established a Benchmark near the site of the work where the new bridge is being constructed. For the new bridge, the plans include details illustrating the work to be carried out. For the bridge detail a Benchmark has been indicated and the Elevation has been shown and may be utilized by the Contractor in carrying out its work. The Contractor shall note that in each case a specific design elevation grade has been provided for the invert at each end of the pipe in the table accompanying each detail. The table also sets out the pipe size, materials, and other requirements relative to the installation of the culvert structure. In all cases, the Contractor is to utilize the specified drain grade to set any new pipe installation. The Contractor shall ensure that it takes note of the direction of flow and sets all pipes to assure that all grades flow from east to west to match the direction of flow within the drain. The Contractor's attention is drawn to the fact that the pipe invert grades established herein provide for the pipes to be set at least 10% of their diameter or pipe rise below the existing drain bottom or the design grade of the drain, whichever is lower.

#### **XI. ANCILLARY WORK**

During the course of any work to the bridge for this project, the Contractor will be required to protect or extend any existing tile ends or swales and connect them to the drainage works to maintain the drainage from the adjacent lands. All existing tiles shall be extended utilizing solid Big 'O' "standard tile ends" or equal plastic pipe of the same diameter as the existing tile and shall be installed in accordance with the "**Standard Lateral Tile Detail**" included in the plans, unless otherwise noted. Connections shall be made using a manufacturer's coupling where possible. Wherever possible, tiles shall be extended to outlet beyond the end of any access culverts. When required, openings into new pipes shall be neatly bored, saw cut or burned with a torch to the satisfaction of the Town Drainage Superintendent or the Consulting Engineer. All cuts to steel pipes shall be touched up with a thick coat of zinc rich paint (Galvicon or equal) in accordance with the manufacturer's recommendations. For other connections, the Contractor shall utilize a grouted connection. Grouted mortar joints shall be composed of three (3) parts of clean, sharp sand to one (1) part of Portland cement with just sufficient water added to provide a stiff plastic mix, and the mortar connection shall be performed to the full satisfaction of the Town Drainage Superintendent or the Consulting Engineer. The mortar joint shall be of a sufficient mass around the full circumference of the joint on the exterior side to ensure a tight, solid seal. The Contractor is to note that any intercepted pipes along the length of the culvert are to be extended and connected to the open drain unless otherwise noted in the accompanying drawings.



Where the bridge installation interferes with the discharge of an existing swale, the Contractor shall re-grade the existing swales to allow for the surface flows to freely enter the drain. Any disturbed grass areas shall be fully restored with topsoil, seed, and mulch.

All granular backfill for the bridge installation shall be satisfactorily compacted in place to a minimum Standard Proctor Density of 98% by means of mechanical compaction equipment. All other good, clean, native fill material or topsoil to be utilized, where applicable, shall be compacted in place to a minimum Standard Proctor Density of 95%. All of the backfill material, equipment used, and method of compacting the backfill material shall be provided and performed to the full satisfaction of the Town Drainage Superintendent or Consulting Engineer.

The Contractor will be responsible to restore any damage caused to these driveways at its cost. All damaged hard surface driveway areas shall be neatly saw cut and the damaged materials removed and disposed of by the Contractor prior to carrying out any restoration work.

The new corrugated aluminized steel type II pipe for this installation is to be provided with a minimum depth of cover measured from the top of the pipe of 305mm (12") for a round pipe and 500mm for a pipe arch. If the bridge culvert pipe is placed at their proper elevations, same should be achieved. If the Contractor finds that the minimum cover is not being met, they shall notify the Town Drainage Superintendent and the Consulting Engineer immediately so that steps can be taken to rectify the condition prior to the placement of any backfill. The minimum cover requirement is **critical** and must be attained. In order for these new access bridge culverts to properly fit the channel parameters, **all of the design grade elevations must be strictly adhered to.**

As a check, all of the above access bridge culvert design grade elevations should be confirmed before commencing to the next stage of the access bridge installation. The Contractor is also to check that the pipe invert grades are correct by referencing the Benchmark.

Although it is anticipated that the culvert installation shall be undertaken in the dry, the Contractor shall supply and install a temporary straw bale or silt curtain check dam in the drain bottom immediately downstream of the culvert site during the time of construction. The straw bale or silt curtain check dam shall be to the satisfaction of the Town Drainage Superintendent or Consulting Engineer and must be removed upon completion of the construction. All costs associated with the supply and installation of this straw bale or silt curtain check dam shall be included in the cost bid for the new bridge installation.

## **XII. TOPSOIL, SEED AND MULCH**

The Contractor shall be required to restore all existing grassed areas and drain side slopes damaged by the structure construction or cutting of the drain cross section, by placing topsoil, and then seed and mulch over said areas including any specific areas noted on the bridge details. The Contractor shall be required to provide all the material and to cover the above mentioned surfaces with approximately 50mm of good, clean, dry topsoil on slopes and 100mm of good,

clean, dry topsoil on horizontal surfaces, fine graded and spread in place ready for seeding and mulching. The placing and grading of any topsoil shall be carefully and meticulously carried out in accordance with Ontario Provincial Standard Specifications, Form 802 dated November 2010, or as subsequently amended, or as amended by these specifications and be readied for the seeding and mulching process. The seeding and mulching of all of the above mentioned areas shall comply in all regards to Ontario Provincial Standard Specifications, Form 803 dated November 2010 and Form 804, dated November 2013, or as subsequently amended, or as amended by these specifications. The seeding mixture shall be the Standard Roadside Mix (Canada No. 1 Lawn Grass Seed Mixture) as set out in O.P.S.S. 804. All cleanup and restoration work shall be performed to the full satisfaction of the Town Drainage Superintendent or Engineer.

When all of the work for this installation has been completed, the Contractor shall ensure that positive drainage is provided to all areas; and shall ensure that the site is left in a neat and workmanlike manner, all to the full satisfaction of the Town Drainage Superintendent or Engineer.

### **XIII. GENERAL CONDITIONS**

- a) The Town Drainage Superintendent or Consulting Engineer shall have authority to carry out minor changes to the work where such changes do not lessen the efficiency of the work.
- b) The Contractor shall satisfy itself as to the exact location, nature and extent of any existing structure, utility, or other object which it may encounter during the course of the work. The Contractor shall indemnify and save harmless the Town of Essex and the Consulting Engineer and their representatives for any damages which it may cause or sustain during the progress of the work. It shall not hold the Town of Essex or the Consulting Engineer liable for any legal action arising out of any claims brought about by such damage caused by it.
- c) The Contractor shall provide a sufficient number of layout stakes and grade points so that the Drainage Superintendent and Consulting Engineer can review same and check that the work will generally conform to the design and project intent.
- d) The Contractor will be responsible for any damage caused by it to any portion of the Town road system, especially to the travelled portion. When excavation work is being carried out and the excavation equipment is placed on the travelled portion of the road, the travelled portion shall be protected by having the excavation equipment placed on satisfactory timber planks or timber pads. If any part of the travelled portion of the road is damaged by the Contractor, the Town shall have the right to have the necessary repair work done by its' employees and the cost of all labour and materials used to carry out the repair work shall be deducted from the Contractor's contract and credited to the Town. The Contractor, upon completing the works, shall clean all debris and junk, etcetera, from the roadside of the drain, and leave the site in a neat and workmanlike manner. The Contractor shall be

responsible for keeping all public roadways utilized for hauling materials free and clear of mud and debris.

- e) The Contractor shall provide all necessary lights, signs, and barricades to protect the public. All work shall be carried out in accordance with the requirements of the Occupational Health and Safety Act, and latest amendments thereto. If traffic control is required on this project, signing is to comply with the M.T.O. Manual of Uniform Traffic Control Devices (M.U.T.C.D.) for Roadway Work Operations and Ontario Traffic Manual Book 7.
- f) During the course of the work the Contractor shall be required to connect existing drainage pipes to the Municipal Drain. In the event that polluted flows are discovered, the Contractor shall delay the connection of the pipe and leave the end exposed and alert the Town, the Drainage Superintendent and the Consulting Engineer so that steps can be taken by the Town to address the concern with the owner and the appropriate authorities. Where necessary the Contractor shall cooperate with the Town in providing temporary measures to divert the drain or safely barricade same. Should the connection be found acceptable by the authorities, the Contractor shall complete the connection of the drain as provided for in the specifications, at no extra cost to the project.
- g) Following the completion of the work, the Contractor is to trim up any broken or damaged limbs on trees which are to remain standing, and it shall dispose of said branches along with other brush, thus leaving the trees in a neat and tidy condition.
- h) The whole of the work shall be satisfactorily cleaned up, and during the course of the construction, no work shall be left in any untidy or incomplete state before subsequent portions are undertaken.
- i) During the course of the project the Contractor shall deal with any excess soil management from the project in accordance with Ontario Reg 406/19 pursuant to the Environmental Protection Act, R.S.O. 1990, c. E.19 and any subsequent amendments to same.
- j) All driveways, laneways and access bridges, or any other means of access on to the job site shall be fully restored to their former condition at the Contractor's expense. Before authorizing Final Payment, the Town Drainage Superintendent and the Consulting Engineer shall inspect the work in order to be sure that the proper restoration has been performed. In the event that the Contractor fails to satisfactorily clean up any portion of these accesses, the Consulting Engineer shall order such cleanup to be carried out by others and the cost of same be deducted from any monies owing to the Contractor.
- k) The Contractor will be required to submit to the Town, a Certificate of Good Standing from the Workplace Safety and Insurance Board prior to the commencement of the work and the Contractor will be required to submit to the Town, a Certificate of Clearance for the project from the Workplace Safety and Insurance Board before Final Payment is made to the Contractor.

- l) The Contractor shall furnish a Performance and Maintenance Bond along with a separate Labour and Material Payment Bond within ten (10) days after notification of the execution of the Agreement by the Town. One copy of said bonds shall be bound into each of the executed sets of the Contract. Each Performance and Maintenance Bond and Labour and Material Payment Bond shall be in the amount of 100% of the total Tender Price. All Bonds shall be executed under corporate seal by the Contractor and a surety company, authorized by law to carry out business in the Province of Ontario. The Bonds shall be acceptable to the Town in every way and shall guarantee faithful performance of the contract during the period of the contract, including the period of guaranteed maintenance which will be in effect for twelve (12) months after substantial completion of the works.

The Tenderer shall include the cost of bonds in the unit price of the Tender items as no additional payment will be made in this regard.

- m) The Contractor shall be required, as part of this Contract, to provide Comprehensive Liability Insurance coverage for not less than \$5,000,000.00 on this project; and shall name the Town of Essex and its' officials and the Consulting Engineer and their staff as additional insured under the policy. The Contractor must submit a copy of this policy to both the Town Clerk and the Consulting Engineer prior to the commencement of work.
- n) Monthly progress orders for payment shall be furnished the Contractor by the Town Drainage Superintendent. Said orders shall be for not more than 90% of the value of the work done and the materials furnished on the site. The paying of the full 90% does not imply that any portion of the work has been accepted. The remaining 10% will be paid 60 days after the final acceptance and completion of the work and payment shall not be authorized until the Contractor provides the following:
- i) a Certificate of Clearance for the project from the Workplace Safety and Insurance Board
  - ii) proof of advertising

The Contractor shall satisfy the Consulting Engineer or Town that there are no liens or claims against the work and that all of the requirements as per the Construction Act, 2018 and its' subsequent amendments have been adhered to by the Contractor.

- o) In the event that the Specifications, Information to Tenderers, or the Form of Agreement do not apply to a specific condition or circumstance with respect to this project, the applicable section or sections from the Canadian Construction Documents Committee C.C.D.C.2 shall govern and be used to establish the requirements of the work.

- p) Should extra work be required by the Town Drainage Superintendent or Consulting Engineer and it is done on a time and material basis, the actual cost of the work will be paid to the Contractor with a 15% markup on the total actual cost of labour, equipment, and materials needed to complete the extra work.

## APPENDIX "REI-A"



**STANDARD E.R.C.A. AND D.F.O.**  
**MITIGATION REQUIREMENTS**

As part of its work, the Contractor will implement the following measures that will ensure that any potential adverse effects on fish and fish habitat will be mitigated:

1. As per standard requirements, work will not be conducted at times when flows in the drain are elevated due to local rain events, storms, or seasonal floods. Work will be done in the dry.
2. All disturbed soils on the drain banks and within the channel, including spoil, must be stabilized immediately upon completion of work. The restoration of the site must be completed to a like or better condition to what existed prior to the works. The spoil material must be hauled away and disposed of at a suitable site, or spread an appropriate distance from the top of the drain bank to ensure that it is not washed back into the drain.
3. To prevent sediment entry into the drain in the event of an unexpected rainfall, silt barriers and/or traps must be placed in the channel during the works and until the site has been stabilized. All sediment and erosion control measures are to be in accordance with the related Ontario Provincial Standards. It is incumbent on the proponent and Contractors to ensure that sediment and erosion control measures are functioning properly and maintained/upgraded as required.
4. Silt or sand accumulated in the barrier traps must be removed and stabilized on land once the site is stabilized.
5. All activities including maintenance procedures should be controlled to prevent the entry of petroleum products, debris, rubble, concrete, or other deleterious substances into the water. Vehicular refuelling and maintenance should be conducted away from the water.
6. Any drain banks trimmed outside of the July 1st to September 15th timing window will require erosion control blankets to be installed to promote re-vegetation and to protect the slope from erosion in the interim.





**SECTION II**

**SPECIFICATIONS**

**FOR FISH SALVAGE**

**GENERAL**  
**SECTION 201**

The Work shall include the capture, salvage and release of fish that are trapped or stranded as the result of the Contractor's operations, at locations identified in the Fish Salvage Plan, and in co-operation with the Essex Region Conservation Authority (E.R.C.A.).

Fish capture shall be performed prior to dewatering, and in such manner that will minimize the injury to the fish.

**MATERIALS**  
**SECTION 202**

All materials required for fish capture, salvage and release shall be supplied by the Contractor.

**CONSTRUCTION**  
**SECTION 203**

The Contractor shall not commence any fish capture, salvage and release work until the Fish Salvage Plan has been accepted by the Consultant and the Conservation Authority. All work shall be performed in accordance with the Fish Salvage Plan unless otherwise determined by the Consultant or the Conservation Authority.

The Contractor shall ensure an ice-free pool is maintained throughout all fish capture and release operations.

All fish shall be captured within the area specified, and released at an acceptable location in the downstream water body. Fish shall be captured by electro fishing, netting, seining, trapping, or other method acceptable to the Consultant and/or the Conservation Authority.

**MEASUREMENT AND PAYMENT**  
**SECTION 204**

Payment for this Work will be made at the lump sum price bid for "Fish Capture and Release". The lump sum price will be considered full compensation for all labour, materials, equipment, tools and incidentals necessary to complete the Work to the satisfaction of the Consultant.



# Measures to Avoid Causing Harm to Fish and Fish Habitat

If you are conducting a project near water, it is your responsibility to ensure you avoid causing [serious harm to fish](#) in compliance with the *Fisheries Act*. The following advice will help you avoid causing harm and comply with the *Act*.

**PLEASE NOTE:** This advice applies to all project types and replaces all “Operational Statements” previously produced by DFO for different project types in all regions.

## Measures

- Time work in water to respect [timing windows](#) to protect fish, including their eggs, juveniles, spawning adults and/or the organisms upon which they feed.
- Minimize duration of in-water work.
- Conduct instream work during periods of low flow, or at low tide, to further reduce the risk to fish and their habitat or to allow work in water to be isolated from flows.
- Schedule work to avoid wet, windy and rainy periods that may increase erosion and sedimentation.
- Design and plan activities and works in waterbody such that loss or disturbance to aquatic habitat is minimized and sensitive spawning habitats are avoided.
- Design and construct approaches to the waterbody such that they are perpendicular to the watercourse to minimize loss or disturbance to riparian vegetation.
- Avoid building structures on meander bends, braided streams, alluvial fans, active floodplains or any other area that is inherently unstable and may result in erosion and scouring of the stream bed or the built structures.
- Undertake all instream activities in isolation of open or flowing water to maintain the natural flow of water downstream and avoid introducing sediment into the watercourse.
- Plan activities near water such that materials such as paint, primers, blasting abrasives, rust solvents, degreasers, grout, or other chemicals do not enter the watercourse.
- Develop a response plan that is to be implemented immediately in the event of a sediment release or spill of a deleterious substance and keep an emergency spill kit on site.
- Ensure that building material used in a watercourse has been handled and treated in a manner to prevent the release or leaching of substances into the water that may be deleterious to fish.

- Develop and implement an Erosion and Sediment Control Plan for the site that minimizes risk of sedimentation of the waterbody during all phases of the project. Erosion and sediment control measures should be maintained until all disturbed ground has been permanently stabilized, suspended sediment has resettled to the bed of the waterbody or settling basin and runoff water is clear. The plan should, where applicable, include:
  - Installation of effective erosion and sediment control measures before starting work to prevent sediment from entering the water body.
  - Measures for managing water flowing onto the site, as well as water being pumped/diverted from the site such that sediment is filtered out prior to the water entering a waterbody. For example, pumping/diversion of water to a vegetated area, construction of a settling basin or other filtration system.
  - Site isolation measures (e.g., silt boom or silt curtain) for containing suspended sediment where in-water work is required (e.g., dredging, underwater cable installation).
  - Measures for containing and stabilizing waste material (e.g., dredging spoils, construction waste and materials, commercial logging waste, uprooted or cut aquatic plants, accumulated debris) above the high water mark of nearby waterbodies to prevent re-entry.
  - Regular inspection and maintenance of erosion and sediment control measures and structures during the course of construction.
  - Repairs to erosion and sediment control measures and structures if damage occurs.
  - Removal of non-biodegradable erosion and sediment control materials once site is stabilized.
- Clearing of riparian vegetation should be kept to a minimum: use existing trails, roads or cut lines wherever possible to avoid disturbance to the riparian vegetation and prevent soil compaction. When practicable, prune or top the vegetation instead of grubbing/uprooting.
- Minimize the removal of natural woody debris, rocks, sand or other materials from the banks, the shoreline or the bed of the waterbody below the ordinary high water mark. If material is removed from the waterbody, set it aside and return it to the original location once construction activities are completed.
- Immediately stabilize shoreline or banks disturbed by any activity associated with the project to prevent erosion and/or sedimentation, preferably through re-vegetation with native species suitable for the site.
- Restore bed and banks of the waterbody to their original contour and gradient; if the original gradient cannot be restored due to instability, a stable gradient that does not obstruct fish passage should be restored.
- If replacement rock reinforcement/armouring is required to stabilize eroding or exposed areas, then ensure that appropriately-sized, clean rock is used; and that rock is installed at a similar slope to maintain a uniform bank/shoreline and natural stream/shoreline alignment.
- Remove all construction materials from site upon project completion.

- Ensure that all in-water activities, or associated in-water structures, do not interfere with fish passage, constrict the channel width, or reduce flows.
- Retain a qualified environmental professional to ensure applicable permits for relocating fish are obtained and to capture any fish trapped within an isolated/enclosed area at the work site and safely relocate them to an appropriate location in the same waters. Fish may need to be relocated again, should flooding occur on the site.
- Screen any water intakes or outlet pipes to prevent entrainment or impingement of fish. Entrainment occurs when a fish is drawn into a water intake and cannot escape. Impingement occurs when an entrapped fish is held in contact with the intake screen and is unable to free itself.
  - In freshwater, follow these measures for design and installation of intake end of pipe fish screens to protect fish where water is extracted from fish-bearing waters:
    - Screens should be located in areas and depths of water with low concentrations of fish throughout the year.
    - Screens should be located away from natural or artificial structures that may attract fish that are migrating, spawning, or in rearing habitat.
    - The screen face should be oriented in the same direction as the flow.
    - Ensure openings in the guides and seals are less than the opening criteria to make “fish tight”.
    - Screens should be located a minimum of 300 mm (12 in.) above the bottom of the watercourse to prevent entrainment of sediment and aquatic organisms associated with the bottom area.
    - Structural support should be provided to the screen panels to prevent sagging and collapse of the screen.
    - Large cylindrical and box-type screens should have a manifold installed in them to ensure even water velocity distribution across the screen surface. The ends of the structure should be made out of solid materials and the end of the manifold capped.
    - Heavier cages or trash racks can be fabricated out of bar or grating to protect the finer fish screen, especially where there is debris loading (woody material, leaves, algae mats, etc.). A 150 mm (6 in.) spacing between bars is typical.
    - Provision should be made for the removal, inspection, and cleaning of screens.
    - Ensure regular maintenance and repair of cleaning apparatus, seals, and screens is carried out to prevent debris-fouling and impingement of fish.
    - Pumps should be shut down when fish screens are removed for inspection and cleaning.
- Avoid using explosives in or near water. Use of explosives in or near water produces shock waves that can damage a fish swim bladder and rupture internal organs. Blasting vibrations may also kill or damage fish eggs or larvae.
  - If explosives are required as part of a project (e.g., removal of structures such as piers, pilings, footings; removal of obstructions such as beaver dams; or preparation of a river or lake bottom for installation of a structure such as a dam or water intake), the potential for impacts to fish and fish habitat should be minimized by implementing the following measures:

- Time in-water work requiring the use of explosives to prevent disruption of vulnerable fish life stages, including eggs and larvae, by adhering to appropriate fisheries [timing windows](#).
- Isolate the work site to exclude fish from within the blast area by using bubble/air curtains (i.e., a column of bubbled water extending from the substrate to the water surface as generated by forcing large volumes of air through a perforated pipe/hose), cofferdams or aquadams.
- Remove any fish trapped within the isolated area and release unharmed beyond the blast area prior to initiating blasting
- Minimize blast charge weights used and subdivide each charge into a series of smaller charges in blast holes (i.e., decking) with a minimum 25 millisecond (1/1000 seconds) delay between charge detonations (see Figure 1).
- Back-fill blast holes (stemmed) with sand or gravel to grade or to streambed/water interface to confine the blast.
- Place blasting mats over top of holes to minimize scattering of blast debris around the area.
- Do not use ammonium nitrate based explosives in or near water due to the production of toxic by-products.
- Remove all blasting debris and other associated equipment/products from the blast area.

**Figure 1: Sample Blasting Arrangement**

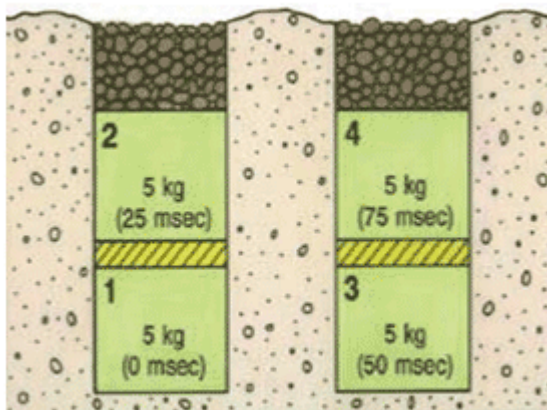

Per Fig. 1: 20 kg total weight of charge; 25 msecs delay between charges and blast holes; and decking of charges within holes.

- Ensure that machinery arrives on site in a clean condition and is maintained free of fluid leaks, invasive species and noxious weeds.

- Whenever possible, operate machinery on land above the high water mark, on ice, or from a floating barge in a manner that minimizes disturbance to the banks and bed of the waterbody.
- Limit machinery fording of the watercourse to a one-time event (i.e., over and back), and only if no alternative crossing method is available. If repeated crossings of the watercourse are required, construct a temporary crossing structure.
- Use temporary crossing structures or other practices to cross streams or waterbodies with steep and highly erodible (e.g., dominated by organic materials and silts) banks and beds. For fording equipment without a temporary crossing structure, use stream bank and bed protection methods (e.g., swamp mats, pads) if minor rutting is likely to occur during fording.
- Wash, refuel and service machinery and store fuel and other materials for the machinery in such a way as to prevent any deleterious substances from entering the water.

Date modified:  
2013-11-25





## APPENDIX "REI-B"



## **SCHEDULE C**

### **MITIGATION PLAN**

The Municipality shall undertake measures to minimize adverse effects on species at risk in accordance with the general conditions described in Part B and taxa-specific conditions described in Part C, and the monitoring and reporting requirements described in Part D of this Mitigation Plan.

#### **PART A. DEFINITIONS**

##### **1. Definitions:**

1.1. In this Schedule, the following words shall have the following meanings:

"DFO" means Fisheries and Oceans Canada;

"MNR" means the Aylmer District Office of the Ministry of Natural Resources;

"Contact" means to contact the MNR in accordance with the notification/contact schedule provided to the Municipality by the MNR Designated Representative from time to time;

"Holding Tub" means a large, light-coloured container fitted with a non-airtight latchable lid approved by the MNR for the temporary storage of captured snakes, turtles, amphibians, birds or eggs;

"Interagency Notification Form" means the form issued by DFO, available at [www.dfo-mpo.gc.ca](http://www.dfo-mpo.gc.ca), which is required to be completed when a drain is being maintained or constructed;

"Monitoring and Reporting Form" means the document that must be completed by the Municipality in accordance with Part D to this Schedule and will be provided to the Municipality;

"Ontario Operational Statement" means one of the documents issued by DFO, available at [www.dfo-mpo.gc.ca](http://www.dfo-mpo.gc.ca), that sets out the conditions and measures to be incorporated into a project in order to avoid negative impacts to fish and fish habitat in Ontario, as modified from time to time;

"Process Charts" means the charts attached as Part E to this Schedule which describe the steps set out in this Mitigation Plan;

"Seasonal Timing Windows Chart" means the chart attached as Part G to this schedule which describes the Sensitive Periods applicable to each Taxonomic Group;

"Sensitive Area" means a geographic area in the Municipality where additional mitigation measures are required to be undertaken for one or more Taxonomic Groups;

"Sensitive Areas Map" means any one of the maps attached as Part F to this schedule which sets out the applicable Sensitive Areas;

"Sensitive Period" means a time of year set out in the Seasonal Timing Windows Chart during which taxa-specific mitigation measures are required to be undertaken for a Taxonomic Group because of ambient air/water temperatures, water-levels or important life-history stages;

"Taxonomic Group" means the distinct group comprising one or more Species based on their taxonomic relationship and common approaches to mitigating adverse effects (i.e., fish, mussels, turtles, snakes, amphibians, birds or plants); and

"Work Zone" means the geographic area in the Municipality where an Activity in respect of one of the Drainage Works is being conducted.

- 1.2. For greater certainty, any defined terms that are not defined in section 1.1 have the same meanings as in the Agreement.

## **PART B. GENERAL MEASURES TO MINIMIZE ADVERSE EFFECTS**

### **2. Process Charts**

- 2.1. The general steps set out in this Part B are visually described in the Process Charts (Part E).

### **3. Review of Documentation**

- 3.1. Prior to conducting any Activities in respect of the Drainage Works the Municipality shall determine if conditions apply to the place, time or manner in which the Municipality wishes to pursue them by reviewing:
  - (a) the Sensitive Areas Maps (Part F) to determine if the Work Zone for the proposed Activities will occur within a Sensitive Area;
  - (b) the DFO Reference Guide for Fish and Mussel Species at Risk Distribution Maps: A Referral Review Tool for Projects Affecting Aquatic Species at Risk;
  - (c) the Seasonal Timing Windows Chart (Part G) to determine if the proposed Activities will occur during a Sensitive Period for one or more of the Taxonomic Groups; and
  - (d) the Process Charts to determine if prior notification is required;
  - (e) the mitigation measures for each applicable Taxonomic Group in Part C to determine what additional site-specific mitigation measures, if any, are required.
- 3.2. The Municipality shall document the results of the review undertaken in accordance with section 3.1 using the Monitoring and Reporting Form.

### **4. Sensitive Areas Maps**

- 4.1. The Sensitive Areas Maps contain sensitive information about the distribution of species at risk, are provided for the sole purpose of informing this Agreement and are not to be copied or distributed for any other purposes or to any other party without the prior written authorization of the MNR Designated Representative.

### **5. Prior Notification to Seek Direction**

- 5.1. If, after completing the review of documents described in section 3.1, the Municipality determines that the proposed Activities will be undertaken:
  - (a) in a place;
  - (b) at a time; or
  - (c) in a manner,that requires prior notification in accordance with the Process Charts, the Municipality shall provide prior notification to the MNR in order for the MNR to determine if the Municipality must undertake additional site-specific or Species-specific mitigation

measures to minimize adverse effects on the Species and, if applicable, to identify such measures.

5.2. The prior notification under section 5.1 shall include a completed Interagency Notification Form:

- (a) in respect of maintenance/repair where the proposed Activities are being undertaken pursuant to subsection 3(18) or section 74 of the *Drainage Act*; or
- (b) in respect of construction/improvement where the proposed Activities are being undertaken pursuant to section 77 or 78 of the *Drainage Act*.

5.3. Where an Activity is undertaken in accordance with section 124 of the *Drainage Act* and would otherwise have required prior notification under section 5.1, the Municipality shall Contact the MNR by email prior to the commencement of the Activity, and complete and submit the applicable Interagency Notification Form within one week of the Activity's completion, unless otherwise directed in writing by the MNR Designated Representative.

**6. General Mitigation Measures**

6.1. Notwithstanding that prior notification or additional mitigation measures may be required in accordance with this schedule, in undertaking any Activity at any time in respect of the Drainage Works the Municipality shall:

- (a) undertake the mitigation measures for sediment control and for erosion control and bank stabilization set out in The Drain Primer (Cliff Evanitski 2008) published by DFO (ISBN 978-0-662-48027-3), unless otherwise authorized in writing by the MNR Designated Representative;
- (b) use net free, 100% biodegradable erosion control blanket for all erosion control or bank stabilization done in conjunction with their Activities or, if authorized in writing by the MNR Designated Representative, alternative erosion control blankets that provide equal or greater protection to individual Species; and
- (c) where applicable, follow the guidelines set out in the following Ontario Operational Statements:
  - (i) Beaver Dam Removal;
  - (ii) Bridge Maintenance;
  - (iii) Culvert Maintenance;
  - (iv) Isolated Pond Construction;
  - (v) Maintenance of Riparian Vegetation in Existing Right of Ways; and
  - (vi) Temporary Stream Crossing.

## **PART C. TAXA-SPECIFIC MEASURES TO MINIMIZE ADVERSE EFFECTS**

### **ADDITIONAL MITIGATION MEASURES FOR MUSSEL SPECIES**

#### **7. Activities undertaken in Sensitive Areas for Mussels**

- 7.1. Subject to section 7.2, where a proposed Activity will occur in a Sensitive Area for a mussel Species, the Municipality shall Contact the MNR to seek further direction.
- 7.2. Section 7.1 does not apply where the applicable Drainage Works are:
  - (a) in a naturally dry condition;
  - (b) classified as a Class F drain in DFO's *Class Authorization System for the Maintenance of Agricultural Municipal Drains in Ontario* (ISBN 0-662-72748-7); or
  - (c) a closed drain.

### **ADDITIONAL MITIGATION MEASURES FOR TURTLE SPECIES**

#### **8. Training and Required On Site Materials for Turtles**

- 8.1. The Municipality will ensure any person:
  - (a) involved in the capture, temporary holding, transfer and release of any turtle Species has received training in proper turtle handling procedures; and
  - (b) who undertakes an Activity has a minimum of two Holding Tubs and cotton sacks on site at all times.

#### **9. Activities undertaken in Sensitive Areas and Sensitive Periods for Turtles**

- 9.1. Subject to section 9.2, where a proposed Activity will occur in a Sensitive Area for any turtle Species and during a Sensitive Period for that Species, the Municipality shall:
  - (a) not undertake any Activities that include the excavation of sediment or disturbance to banks during the applicable Sensitive Period unless otherwise authorized;
  - (b) undertake Activities in accordance with any additional site-specific measures provided in writing by the MNR Designated Representative;
  - (c) avoid draw-down and de-watering of the Sensitive Area during the applicable Sensitive Period; and
  - (d) if authorized by the MNR Designated Representative under (a) above to undertake Activities that include excavation of sediment or disturbance of banks, in addition to any other measures required under (b) above, ensure any person undertaking an Activity has at least two Holding Tubs on site at all times.
- 9.2. Section 9.1 does not apply where the applicable Drainage Works are:
  - (a) in a naturally dry condition;
  - (b) classified as a Class F drain in DFO's *Class Authorization System for the Maintenance of Agricultural Municipal Drains in Ontario* (ISBN 0-662-72748-7); or
  - (c) a closed drain.

## **10. Measures for Encounters with Turtles During a Sensitive Period**

- 10.1. Where one or more individuals belonging to a turtle Species is encountered in the undertaking of an Activity in any part of a Work Zone (including, but not limited to, a Sensitive Area) during a Sensitive Period for that Species, the Municipality shall:
- (a) capture and transfer all uninjured individuals of that Species into a Holding Tub;
  - (b) capture and transfer all individuals injured as a result of the Activities into a Holding Tub separate from any Holding Tub containing uninjured individuals;
  - (c) ensure that the Holding Tubs with the captured individuals are stored at a cool temperature to prevent freezing until the individuals can be transferred; and
  - (d) immediately Contact the MNR to seek direction and to arrange for the transfer of the individual turtles.

## **11. Measures for Encounters with Turtles Laying Eggs or Nest Sites**

- 11.1. Where one or more individuals belonging to a turtle Species laying eggs, or an active nest site of any turtle Species, is encountered in undertaking an Activity in a Work Zone, the Municipality shall:
- (a) not disturb a turtle encountered laying eggs and not conduct any Activities within 20 metres of the turtle while it is laying eggs;
  - (b) collect any displaced or damaged eggs and capture any injured dispersing juveniles and transfer them to a Holding Tub;
  - (c) store all captured injured individuals and collected eggs out of direct sunlight;
  - (d) immediately Contact the MNR to seek direction and to arrange for the transfer of any injured individuals and eggs;
  - (e) immediately stop any disturbance to the nest site and recover exposed portions with soil or organic material to protect the integrity of the remaining individuals;
  - (f) not drive any equipment over the nest site or conduct any Activities within 5 metres of the nest site;
  - (g) not place any dredged materials removed from the Drainage Works on top of the nest site;
  - (h) mark out the physical location of the nest site for the duration of the project but not by any means that might increase the susceptibility of the nest to predation or poaching; and
  - (i) where there are no collected eggs or captured individuals, record relevant information and Contact the MNR within 72 hours to provide information on the location of the nest site.

## **12. Measures for Encounters with Turtles Outside of a Sensitive Period**

- 12.1. Where one or more individuals belonging to a turtle Species is encountered while undertaking an Activity in any part of a Work Zone (including, but not limited to, a Sensitive Area) but outside of any Sensitive Period for that Species, the Municipality shall:
- (a) briefly stop the Activity for a reasonable period of time to allow any uninjured individual turtles of that Species to leave the Work Zone;



- (b) where individuals do not leave the Work Zone after the Activity is briefly stopped in accordance with (a) above, capture all uninjured individuals and release them in accordance with section 13.1;
- (c) where circumstances do not allow for their immediate release, transfer captured uninjured individuals for a maximum of 24 hours into a Holding Tub which shall be stored out of direct sunlight and then release them in accordance with section 13.1;
- (d) capture and transfer any individuals that have been injured into a Holding Tub separate from any Holding Tub containing uninjured individuals; and
- (e) store all captured injured individuals out of direct sunlight and immediately Contact the MNR to seek direction and to arrange for their transfer.

### **13. Release of Captured Individuals Outside of a Sensitive Period**

- 13.1. Where uninjured individuals are captured under section 12.1, they shall be released:
  - (a) within 24 hours of capture;
  - (b) in an area immediately adjacent to the Drainage Works;
  - (c) in an area that will not be further impacted by the undertaking of any Activity; and
  - (d) not more than 250 metres from the capture site.
- 13.2. Following a release under section 13.1, the Municipality shall Contact the MNR within 72 hours of the release to provide information on the name of the Drainage Works, the location of the encounter and the location of the release site.

### **14. Measures for Dead Turtles**

- 14.1. Where one or more individuals of a turtle Species is killed as a result of an Activity in a Work Zone, or if a person undertaking an Activity finds a deceased individual of a turtle Species within the Work Zone, the Municipality shall:
  - (a) place any dead turtles in a Holding Tub outside of direct sunlight; and
  - (b) Contact the MNR within 72 hours to seek direction and to arrange for the transfer of the dead individuals.

## **ADDITIONAL MITIGATION MEASURES FOR SNAKE SPECIES**

### **15. Training and Required On Site Materials for Snakes**

- 15.1. The Municipality will ensure any person:
  - (a) involved in the capture, temporary holding, transfer and release of any snake Species has received training in proper snake handling procedures; and
  - (b) who undertakes an Activity has a minimum of two Holding Tubs and cotton sacks on site at all times.

### **16. Activities undertaken in Sensitive Areas and Sensitive Periods for Snakes**

- 16.1. Where a proposed Activity involves physical infrastructure (e.g., culverts, pump houses, etc.) and will occur in a Sensitive Area for any snake Species and during a *Sensitive Period – Hibernation* for that Species, the Municipality shall undertake the Activity outside of the Sensitive Period, unless otherwise authorized by and in accordance with any site-specific measures provided in writing by the MNR Designated Representative.

16.2. Where a proposed Activity will occur at or adjacent to a known hibernacula (as identified by the MNR) for any snake Species and during a *Sensitive Period – Staging* for that Species, the Municipality shall:

- (a) erect effective temporary snake barriers approved by the MNR that will not pose a risk of entanglement for snakes and that shall be secured so that individual snakes may not pass over or under the barrier or between any openings to enter or re-enter the Work Zone;
- (b) inspect the temporary snake barriers daily during periods when snakes are active, capture any individuals incidentally encountered within the area bounded by the snake barrier and release the captured individuals in accordance with section 20.1; and
- (c) remove the temporary snake barriers immediately upon completion of the Activity.

16.3. Where a proposed Activity that does not involve physical infrastructure will occur in a Sensitive Area for any snake Species and during a *Sensitive Period – Staging* for that Species, the Municipality shall undertake the Activity outside of the Sensitive Period, unless otherwise authorized by and in accordance with any site-specific measures provided in writing by the MNR Designated Representative.

#### **17. Measures for Encounters with Snakes During a Sensitive Period**

17.1. Where one or more individuals belonging to a snake Species is encountered, or should an active hibernacula be uncovered, while conducting an Activity in any part of a Work Zone (including, but not limited to, a Sensitive Area) during a Sensitive Period for that Species, the Municipality shall:

- (a) capture and transfer all injured and uninjured individual snakes of that Species into individual light-coloured, drawstring cotton sacks;
- (b) place all cotton sacks filled with the captured individuals into a Holding Tub;
- (c) ensure that the Holding Tub with the captured individuals is stored at a cool temperature to protect the snakes from freezing until the individuals can be retrieved or transferred;
- (d) if an active hibernacula is uncovered, cease all Activities at the hibernacula site; and
- (e) immediately Contact the MNR to seek direction and to arrange for the transfer and/or retrieval.

#### **18. Measures for Encounters with Snake Nests**

18.1. Where an active nest of any of the snake Species is encountered and disturbed while undertaking an Activity in any part of a Work Zone, the Municipality shall:

- (a) collect any displaced or damaged eggs and transfer them to a Holding Tub;
- (b) capture and transfer all injured dispersing juveniles of that Species into a light-coloured drawstring cotton sack;
- (c) place all cotton sacks with the captured injured individuals into a Holding Tub;
- (d) ensure that the Holding Tub with the captured injured individuals is stored out of direct sunlight;
- (e) immediately Contact the MNR to seek direction and to arrange for the transfer of the injured individuals;
- (f) immediately stop any disturbance to the nest site and loosely cover exposed portions with soil or organic material to protect the integrity of the remaining individuals;

- (g) not drive any equipment over the nest site or conduct any Activities within 5 metres of the nest site;
- (h) not place any dredged materials removed from the Drainage Works on top of the nest site;
- (i) mark out the physical location of the nest site but not by any means that might increase the susceptibility of the nest to predation or poaching; and
- (j) where there are no collected eggs or captured individuals, Contact the MNR within 72 hours to provide information on the location of the nest site.

#### **19. Measures for Encounters with Snakes Outside of a Sensitive Period**

- 19.1. Where one or more individuals belonging to a snake Species is encountered while undertaking an Activity in any part of a Work Zone (including, but not limited to, a Sensitive Area) but outside of any Sensitive Period for that Species, the Municipality shall:
- (a) follow the requirements in section 15;
  - (b) briefly stop the Activity for a reasonable period of time to allow any uninjured individual snakes of that Species to leave the Work Zone;
  - (c) if the individuals do not leave the Work Zone after the Activity is briefly stopped in accordance with (b) above, capture all uninjured individuals and release them in accordance with section 20.1;
  - (d) where circumstances do not allow for the immediate release of captured uninjured individuals, they may be transferred into individual, light-coloured, drawstring cotton sacks before placing them in a Holding Tub which shall be stored out of direct sunlight for a maximum of 24 hours before releasing them in accordance with section 20.1;
  - (e) capture and transfer any individuals injured as a result of conducting the Activities into a Holding Tub separate from any Holding Tub containing uninjured individuals; and
  - (f) store all captured injured individuals out of direct sunlight and immediately Contact the MNR to seek direction and to arrange for their transfer.

#### **20. Release of Captured Individuals Outside of a Sensitive Period**

- 20.1. Where uninjured individuals are captured under section 19.1, they shall be released:
- (a) within 24 hours of capture;
  - (b) in an area immediately adjacent to the Drainage Works where there is natural vegetation cover;
  - (c) in an area that will not be further impacted by the undertaking of any Activity; and
  - (d) not more than 250 metres from the capture site.
- 20.2. Following a release under section 20.1, the Municipality shall Contact the MNR within 72 hours of the release to provide information on the name of the Drainage Works, the location of the encounter and the location of the release site.

#### **21. Measures for Dead Snakes**

- 21.1. Where one or more individuals belonging to a snake Species is killed as a result of an Activity in a Work Zone, or if a person undertaking an Activity finds a deceased individual of a snake Species within the Work Zone, the Municipality shall:

- (a) collect and transfer any dead individuals into a Holding Tub outside of direct sunlight; and
- (b) Contact the MNR within 72 hours to seek direction and to arrange for the transfer of the carcasses of the dead individuals.

#### **ADDITIONAL MITIGATION MEASURES FOR HERBACEOUS PLANTS**

##### **22. Activities Undertaken in Sensitive Areas for Herbaceous Plants**

- 22.1. Where a proposed Activity will occur that involves physical disturbance to vegetated banks or the killing and/or removal of vegetation through chemical or mechanical means in a Sensitive Area for any herbaceous plant Species, the Municipality shall:
- (a) undertake the Activity outside of the Sensitive Period, unless otherwise authorized;
  - (b) limit equipment access and operations to the side of the Drainage Works that will minimize disturbances where any of the plant Species occur;
  - (c) locate temporary storage sites for excavated sediments or bank materials on areas of open soil away from where any of the plant Species are likely to occur;
  - (d) not use any broad spectrum herbicides in Sensitive Areas; and
  - (e) undertake Activities in accordance with any additional site-specific measures provided in writing by the MNR Designated Representative.

#### **ADDITIONAL MITIGATION MEASURES FOR TREE SPECIES**

##### **23. Additional Measures for Butternut**

- 23.1. Where Butternuts may exist in a Work Zone and may be affected by an Activity, the Municipality shall:
- (a) identify and mark as retainable trees all individual Butternut trees within the Work Zone during work planning site visits unless the individual Butternut has been assessed as a non-retainable tree due to infection by Butternut canker by a person designated by the Minister as a Butternut Health Assessor;
  - (b) retain and avoid disturbance to all individuals identified under (a) above that have been identified as retainable trees or that have not been assessed, unless otherwise authorized in writing by the MNR Designated Representative;
  - (c) conduct Activities by:
    - (i) limiting equipment access and operations to the side of the Drainage Works that will minimize disturbance to where any of the individual Butternut trees occur,
    - (ii) working around trees,
    - (iii) avoiding compacting and/or disturbing the soil by keeping excavation and other heavy equipment a minimum of 2 metres away from the main stem of retained individuals to avoid damaging roots and stems,
    - (iv) placing excavated materials on areas not within 2 metres of the main stem of retained individuals; and
    - (v) where branches are required to be removed to allow for safe operation of equipment, removing them using appropriate equipment, such as pruning saws, chain saws or lopping shears, in accordance with good forestry practices.

#### **24. Measures for Other Trees**

- 24.1. Where Kentucky Coffee-tree, Common Hoptree, Eastern Flowering Dogwood and American Chestnut may exist in a Work Zone and may be affected by an Activity, the Municipality shall:
- (a) identify and mark all individual Kentucky Coffee-tree, Common Hoptree, Eastern Flowering Dogwood and American Chestnut within the Work Zone during work planning site visits;
  - (b) avoid disturbance to all individuals identified under (a) above, unless otherwise authorized in writing by the MNR Designated Representative;
  - (c) conduct Activities by:
    - (i) limiting equipment access and operations to the side of the Drainage Works that will minimize disturbance where any of the individuals occur,
    - (ii) working around trees,
    - (iii) avoiding compacting and/or disturbing the soil by keeping excavation and other heavy equipment a minimum of 2 metres away from the main stem of retained individuals to avoid damaging roots and stems, and
    - (iv) placing excavated materials on areas not within 2 metres of the main stem of retained individuals; and
  - (d) where branches are required to be removed to allow for safe operation of equipment, remove them using appropriate equipment, such as pruning saws, chain saws or lopping shears, in accordance with good forestry practices.

#### **PART D. MONITORING AND REPORTING REQUIREMENTS**

##### **25. Compliance Monitoring.**

- 25.1. The Municipality shall inspect the undertaking of the Activities at the locations described in Part F of this Schedule C, and shall record the results of the inspections in the Monitoring and Reporting Form.
- 25.2. The Municipality shall record all encounters with Species and the resulting mitigation measures taken by the Municipality in the Monitoring and Reporting Form.

##### **26. Reporting**

- 26.1. Prior to March 31 of each year the Mitigation Plan is in effect, the Municipality shall submit a completed Monitoring and Reporting Form containing all of the information collected under sections 25.1 and 25.2 during the previous twelve months to the MNR Designated Representative.

##### **27. Review**

- 27.1. Within six months of the expiry of this Mitigation Plan but no later than three months from the time of its expiry, the Parties shall meet to review the measures and actions taken and the Activities undertaken during its term and to discuss the terms and conditions of the next Mitigation Plan.

## APPENDIX "REI-C"



## **STANDARD SPECIFICATIONS** **FOR ACCESS BRIDGE CONSTRUCTION**

### **1. PRECAST CONCRETE BLOCK & CONCRETE FILLED JUTE BAG HEADWALLS**

After the Contractor has set the endwall foundations and the new pipe in place, it shall completely backfill same and install new precast concrete blocks or concrete filled jute bag headwalls at the locations and parameters indicated on the drawing. All concrete used for headwalls shall be a minimum of 30 mPa at 28 days and include 6% +/- 1% air entrainment.

Precast concrete blocks shall be interlocking and have a minimum size of 600mmX600mmX1200mm. Half blocks shall be used to offset vertical joints. Cap blocks shall be a minimum of 300mm thick. A foundation comprising minimum 300mm thick poured concrete or precast blocks the depth of the wall and the full bottom width of the drain plus 450mm embedment into each drain bank shall be provided and placed on a firm foundation as noted below. The Contractor shall provide a levelling course comprising a minimum thickness of 150mm Granular "A" compacted to 100% Standard Proctor Density or 20mm clear stone, or a lean concrete as the base for the foundation. The base shall be constructed level and flat to improve the speed of installation. Equipment shall be provided as required and recommended by the block supplier for placing the blocks such as a swift lift device for the blocks and a 75mm eye bolt to place the concrete caps,. The headwall shall extend a minimum of 150mm below the invert of the access bridge culvert with the top of the headwall set to match the finished driveway grade, unless a 150mm high curb is specified at the edge of the driveway. To achieve the required top elevation, the bottom course of blocks and footing may require additional embedment into the drain bottom. The Contractor shall provide shop drawings of the proposed wall for approval by the Drainage Superintendent or Engineer prior to construction.

Blocks shall be placed so that all vertical joints are staggered. Excavation voids on the ends of each block course shall be backfilled with 20mm clear stone to support the next course of blocks above. Walls that are more than 3 courses in height shall be battered a minimum of 1 unit horizontal for every 5 units of vertical height. The batter shall be achieved by careful grading of the footing and foundation base, or use of pre-battered base course blocks. Filter cloth as specified below shall be placed behind the blocks to prevent the migration of any fill material through the joints. Backfill material shall be granular as specified below. Where the wall height exceeds 1.8 metres in height, a uni-axial geogrid SG350 or equivalent shall be used to tie back the walls and be installed in accordance with the manufacturer's recommendations. The wall face shall not extend beyond the end of the access bridge pipe. Non-shrink grout shall be used to fill any gaps between the blocks and the access bridge pipe for the full depth of the wall. The grout face shall be finished to match the precast concrete block walls as closely as possible.

When constructing the concrete filled jute bag headwalls, the Contractor shall place the bags so that the completed headwall will have a slope inward from the bottom of the pipe to the top of the finished headwall. The slope of the headwall shall be one unit horizontal to five units vertical. The Contractor shall completely backfill behind the new concrete filled jute bag headwalls with Granular "B" and Granular "A" material as per O.P.S.S. Form 1010 and the granular material shall be compacted in place to a Standard Proctor Density of 100%. The placing of the jute bag headwalls and the backfilling shall be performed in lifts simultaneously. The granular backfill shall be placed and compacted in lifts not to exceed 305mm (12") in thickness.

The concrete filled jute bag headwalls shall be constructed by filling jute bags with concrete. All concrete used to fill the jute bags shall have a minimum compressive strength of 25 MPa in 28 days and shall be provided and placed only as a wet mix. Under no circumstance shall the concrete to be used for filling the jute bags be placed as a dry mix. The jute bags, before being filled with concrete, shall have a dimension of 460mm (18") x 660mm (26"). The jute bags shall be filled with concrete so that when they are laid flat, they will be approximately 100mm (4") thick, 305mm (12") to 380mm (15") wide and 460mm (18") long.

The concrete jute bag headwall to be provided at the end of the bridge pipe shall be a single or double bag wall construction as set out in the specifications. The concrete filled bags shall be laid so that the 460mm (18") dimension is parallel with the length of the new pipe. The concrete filled jute bags shall be laid on a footing of plain concrete being 460mm (18") wide, and extending for the full length of the wall, and 305mm (12") thick extending below the bottom of the culvert pipe.

All concrete used for the footing, cap and bags shall have a minimum compressive strength of 30 mPa at 28 days and shall include 6% ± 1% air entrainment.

Upon completion of the jute bag headwall the Contractor shall cap the top row of concrete filled bags with a layer of plain concrete, minimum 100mm (4") thick, and hand trowelled to obtain a pleasing appearance. If the cap is made more than 100mm thick, the Contractor shall provide two (2) continuous 15M reinforcing bars set at mid-depth and equally spaced in



the cap. The Contractor shall fill all voids between the concrete filled jute bags and the corrugated steel pipe with concrete, particular care being taken underneath the pipe haunches to fill all voids.

The completed jute bag headwalls shall be securely embedded into the drain bank a minimum of 450mm (18") measured perpendicular to the sideslopes of the drain.

As an alternate to constructing a concrete filled jute bag headwall, the Contractor may construct a grouted concrete rip rap headwall. The specifications for the installation of a concrete filled jute bag headwall shall be followed with the exception that broken pieces of concrete may be substituted for the jute bags. The concrete rip rap shall be approximately 460mm (18") square and 100mm (4") thick and shall have two (2) flat parallel sides. The concrete rip rap shall be fully mortared in place using a mixture composed of three (3) parts of clean sharp sand and one (1) part of Portland cement.

The complete placement and backfilling of the headwalls shall be performed to the full satisfaction of the Drainage Superintendent and the Engineer.

## **2. QUARRIED LIMESTONE ENDWALLS**

The backfill over the ends of the corrugated steel pipe shall be set on a slope of 1-½ units horizontal to 1 unit vertical from the bottom of the corrugated steel pipe to the top of each end slope and between the drain banks. The top 305mm (12") in thickness of the backfill over the ends of the corrugated steel pipe shall be quarried limestone. The quarried limestone shall also be placed on a slope of 1-½ units horizontal to 1 unit vertical from the bottom of the corrugated steel pipe to the top of each bank of the drain adjacent each end slope. The quarried limestone shall have a minimum dimension of 100mm (4") and a maximum dimension of 250mm (10"). The end slope protection shall be placed with the quarried limestone pieces carefully tamped into place with the use of a shovel bucket so that, when complete, the end protection shall be consistent, uniform, and tightly laid in place.

Prior to placing the quarried limestone end protection over the granular backfill and on the drain banks, the Contractor shall lay non-woven geotextile filter fabric "GMN160" conforming to O.P.S.S. 1860 Class I or approved equal. The geotextile filter fabric shall extend from the bottom of the corrugated steel pipe to the top of each end slope of the bridge and along both banks of the drain to a point opposite the ends of the pipe.

The Contractor shall take extreme care not to damage the geotextile filter fabric when placing the quarried limestone on top of the filter fabric.

## **3. BRIDGE BACKFILL**

After the corrugated steel pipe has been set in place, the Contractor shall backfill the pipe with Granular "B" material, O.P.S.S. Form 1010 with the exception of the top 305mm (12") of the backfill. The top 305mm (12") of the backfill for the full width of the excavated area (between each bank of the drain) and for the top width of the driveway, shall be Granular "A" material, O.P.S.S. Form 1010. The granular backfill shall be compacted in place to a Standard Proctor Density of 100% by means of mechanical compactors. All of the backfill material, equipment used, and method of compacting the backfill material shall be inspected and approved and meet with the full satisfaction of the Drainage Superintendent and Engineer.

## **4. GENERAL**

Prior to the work commencing, the Drainage Superintendent and Engineer must be notified, and under no circumstances shall work begin without one of them being at the site. Furthermore, the grade setting of the pipe must be checked, confirmed, and approved by the Drainage Superintendent or Engineer prior to continuing on with the bridge installation.

The alignment of the new bridge culvert pipe shall be in the centreline of the existing drain, and the placing of same must be performed totally in the dry.

Prior to the installation of the new access bridge culvert, the existing sediment build-up in the drain bottom must be excavated and completely removed. This must be done not only along the drain where the bridge culvert pipe is to be installed, but also for a distance of 3.05 metres (10 ft.) both upstream and downstream of said new access bridge culvert. When setting the new bridge culvert pipe in place it must be founded on a good undisturbed base. If unsound soil is encountered, it must be totally removed and replaced with 20mm (3/4") clear stone, satisfactorily compacted in place.

When doing the excavation work or any other portion of the work relative to the bridge installation, care should be taken not to interfere with, plug up, or damage any existing surface drains, swales, and lateral or main tile ends. Where damage is encountered, repairs to correct same must be performed immediately as part of the work.

The Contractor and/or landowner performing the bridge installation shall satisfy themselves as to the exact location, nature and extent of any existing structure, utility or other object that they may encounter during the course of the work. The Contractor shall indemnify and save harmless the Town, or the Municipality, the Engineer, and their staff from any damages which it may cause or sustain during the progress of the work. It shall not hold them liable for any legal action arising out of any claims brought about by such damage caused by it.

Where applicable, the Contractor and/or landowner constructing the new bridge shall be responsible for any damage caused by them to any portion of the Town road right-of-way. They shall take whatever precautions are necessary to cause a minimum of damage to same and must restore the roadway to its original condition upon completion of the works.

When working along a municipal roadway, the Contractor shall provide all necessary lights, signs, barricades and flagpersons as required to protect the public. All work shall be carried out in accordance with the requirements of the Occupational Health and Safety Act, and latest amendments thereto. If traffic control is required on this project, it is to comply with the M.T.O. Traffic Control Manual for Roadway Work Operations and Ontario Traffic Manual Book 7.

Once the bridge installation has been completed, the drain sideslopes directly adjacent the new headwalls and/or endwalls are to be completely restored including revegetation, where necessary.

All of the work required towards the installation of the bridge shall be performed in a neat and workmanlike manner. The general site shall be restored to its' original condition, and the general area shall be cleaned of all debris and junk, etc. caused by the work

All of the excavation, installation procedures, and parameters as above mentioned are to be carried out and performed to the full satisfaction of the Drainage Superintendent and Engineer.

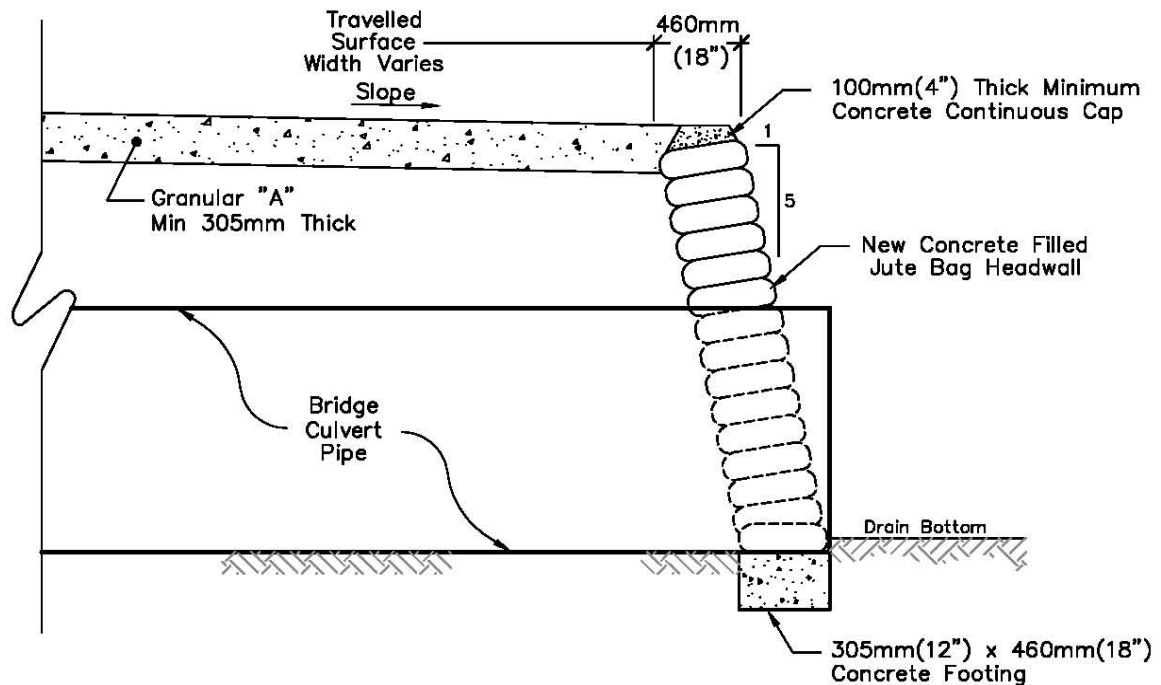

Typical Jute Bag Headwall

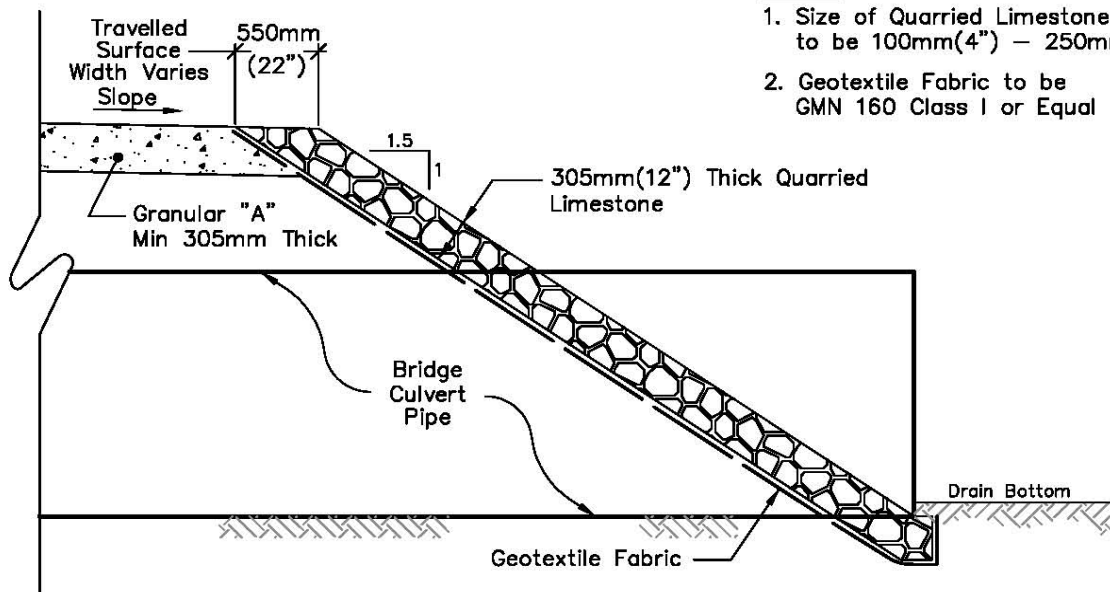

**NOTE:**

1. Size of Quarried Limestone to be 100mm(4") – 250mm(10")
2. Geotextile Fabric to be GMN 160 Class I or Equal

Typical Quarried Limestone End Protection

***Rood Engineering Inc.***  
***Consulting Engineers***  
 9 Nelson Street  
 Leamington, Ontario N8H 1G6  
 519-322-1621

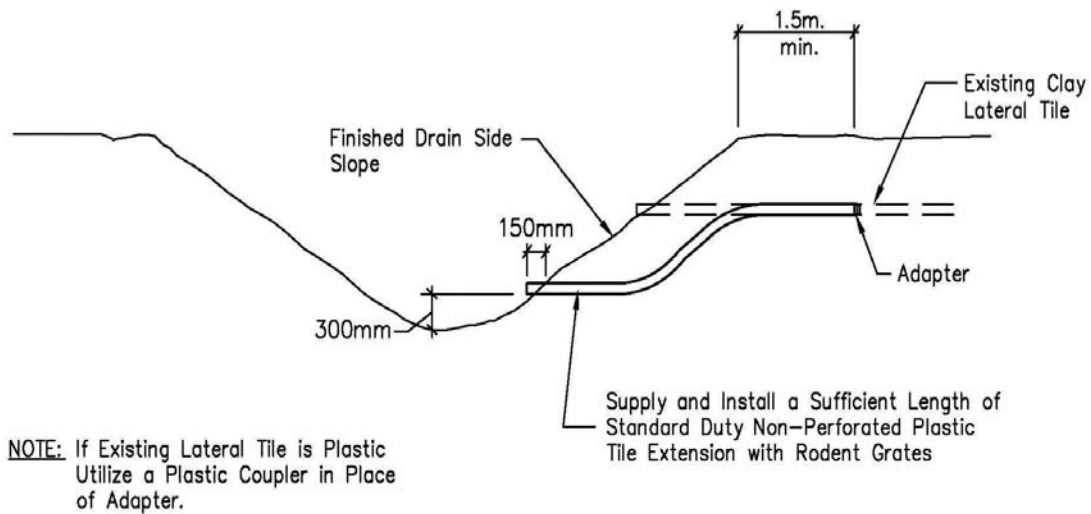

## STANDARD LATERAL TILE DETAIL

N.T.S.

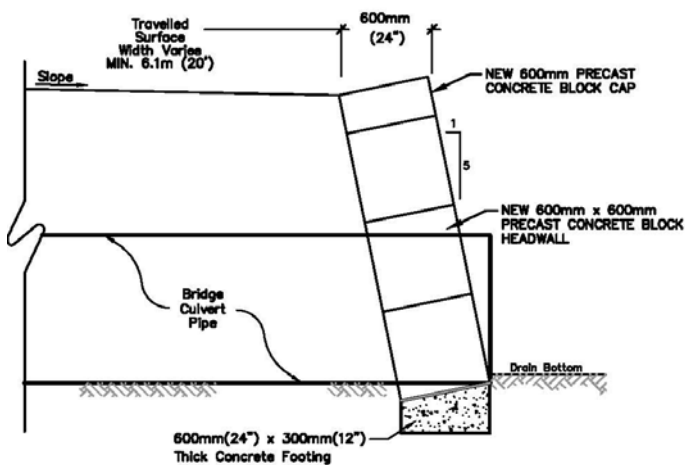

**TYPICAL PRECAST CONCRETE BLOCK END PROTECTION**

Scale = N.T.S.

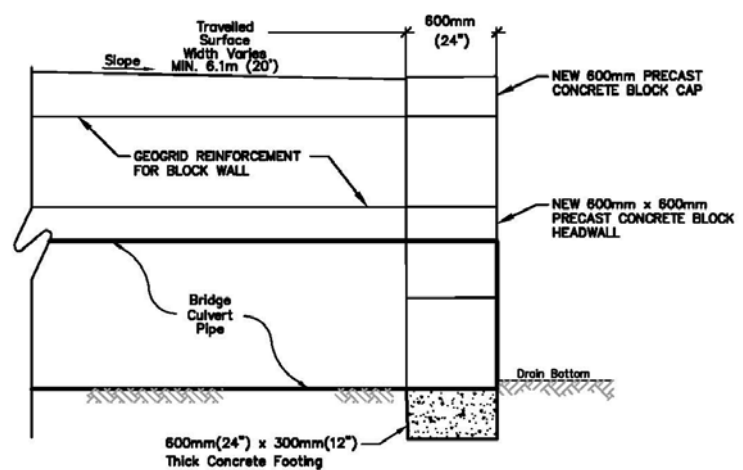

**TYPICAL VERTICAL PRECAST CONCRETE BLOCK END PROTECTION**

Scale = N.T.S.



## APPENDIX "REI-D"



Appendix D – General Conditions and Specifications not required.





## APPENDIX "REI-E"





# Legend

**Roads**

- County Roads
- Municipal
- Private
- Provincial

**Essex Assessment**

**Drainage**

- C
- D
- E
- F
- NR
- N/A
- NC

**Drainage Direction**

**Water**

**Essex County Municipalities**

***Rood Engineering Inc.***  
Consulting Engineers  
9 Nelson Street  
Leamington, Ontario N8H 1G6  
519-322-1621  
2020-09-24

0 166.69 333.4  
Meters  
1: 10,000 5/1/2020

Notes
Grondin Bridge REI2020D010

THIS MAP IS NOT TO BE USED FOR NAVIGATION  
Copyright the Corporation of the Town of Essex, 2019. Data herein is provided  
by the Corporation of the Town of Essex on an 'as is' basis. Assessment parcel  
provided by Teranet Enterprises Inc. Data layers that appear on this map may  
or may not be accurate, current, or otherwise reliable.



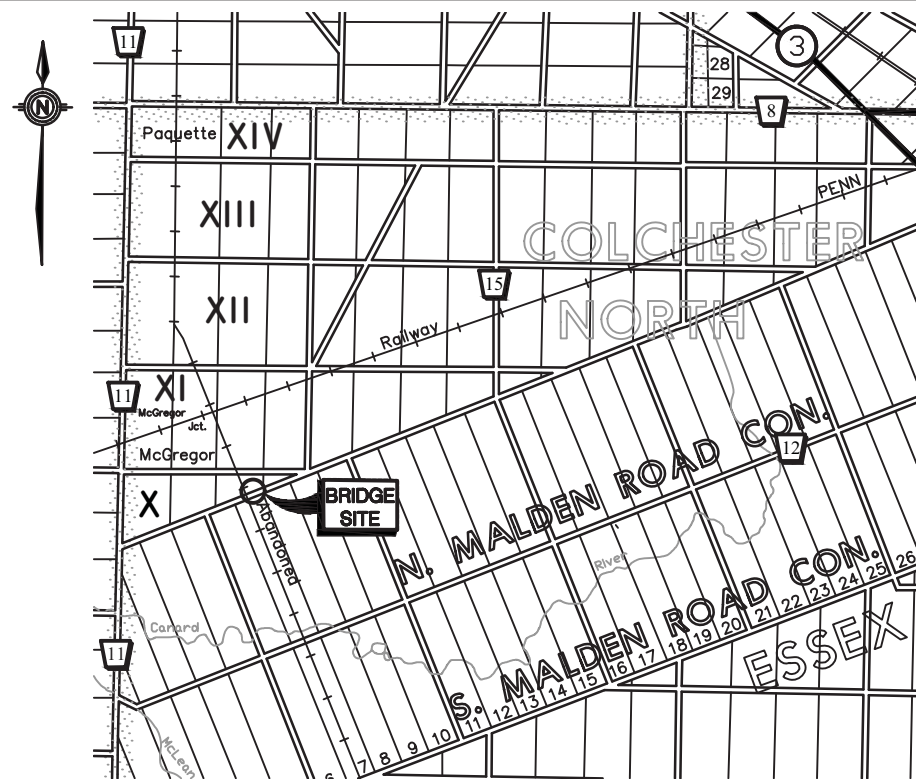

**KEY PLAN**  
Scale = 1:100,000

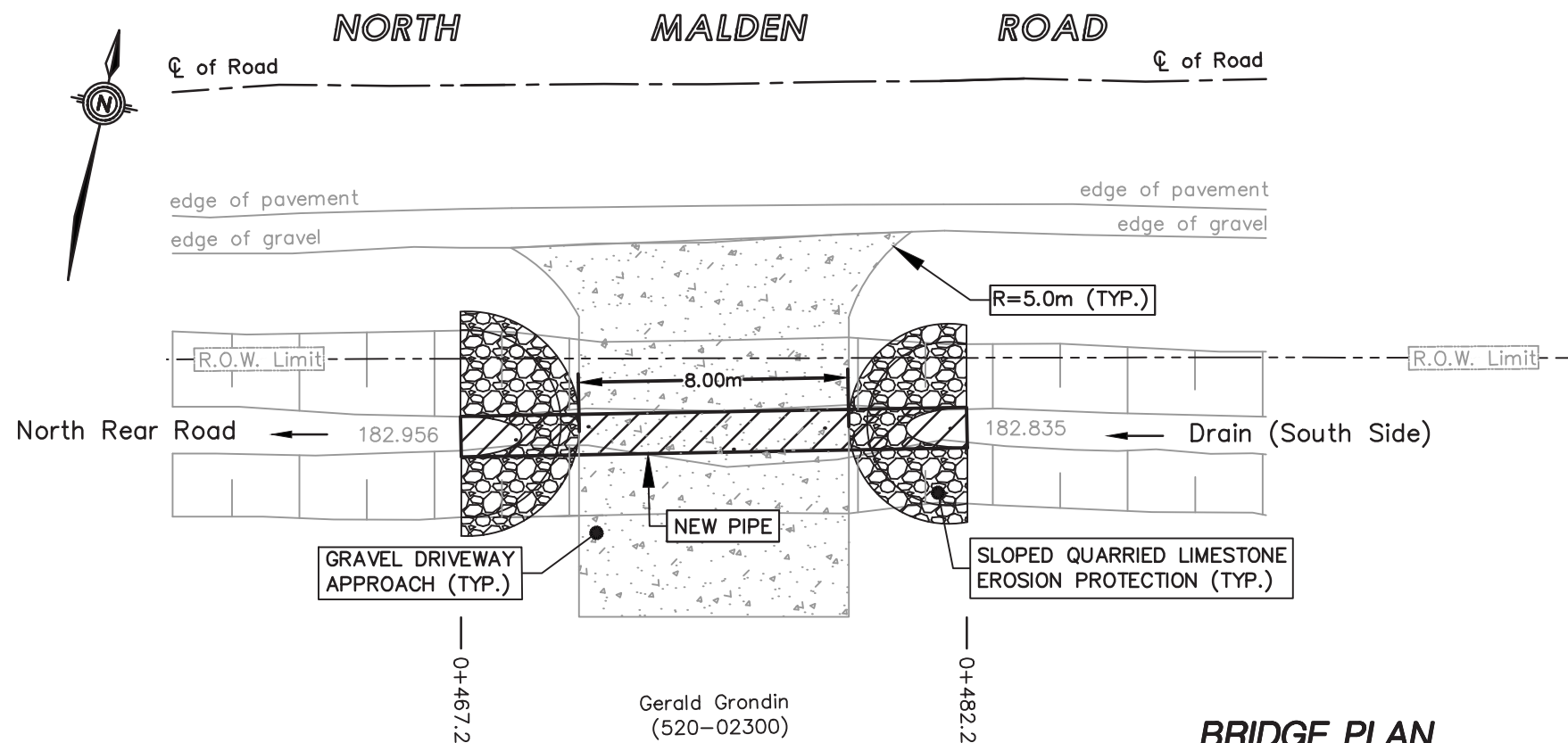
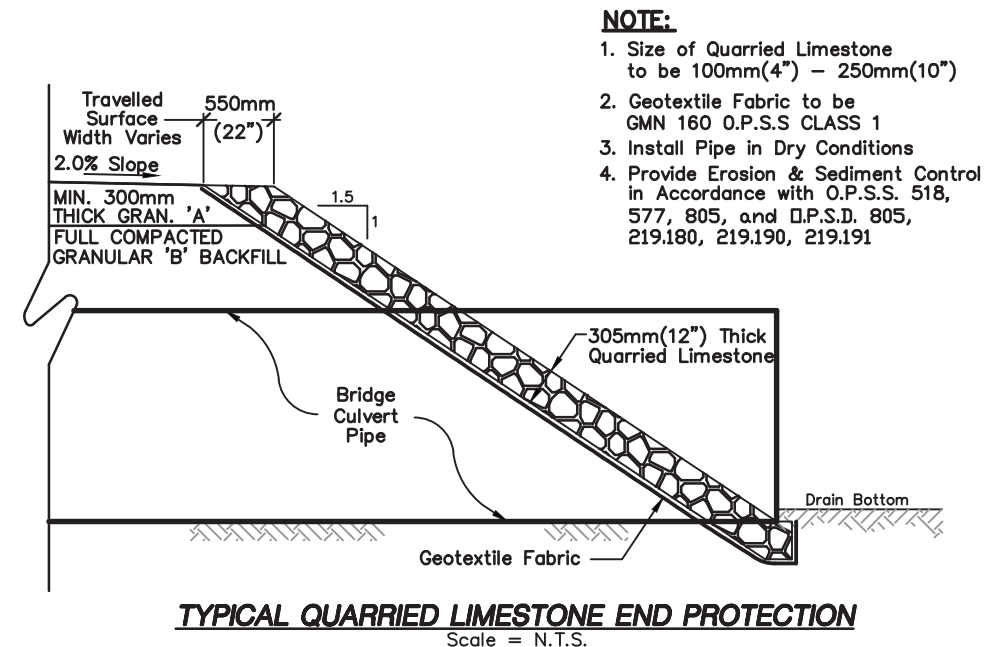

**BRIDGE PLAN**  
SCALE = 1:200

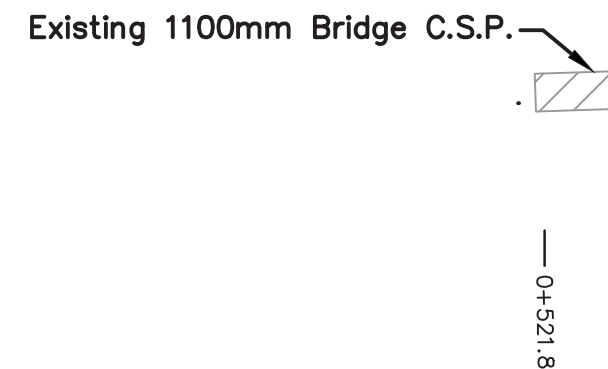

**NOTE:**  
REMOVE EXISTING TREES & BRUSH WITHIN NEW BRIDGE INSTALLATION

**BENCHMARK:**  
TOP CENTER OF WEST CURB ON FARM ACCESS BRIDGE OVER THE 11TH CONCESSION & NORTH REAR ROAD DRAIN, APPROX. 46m EAST OF THE KING CREEK DRAIN ROAD CROSSING  
**ELEV. = 184.902m**

PIPE SIZE:	PIPE LENGTH:	PIPE GAUGE:	CORRUGATIONS:	TYPE OF PIPE:	DESIGN ELEVATIONS:
1200mm	15.0m (49.21 FT.)	2.0mm (14 GA.)	125x25mm (5"x1")	ALUMINIZED C.S.P.	UPSTREAM INV. (E) =182.943m DOWNSTREAM INV. (W) =182.931m TOP OF DRIVEWAY =184.670m DRAIN GRADE = 0.08%

**NORTH REAR ROAD DRAIN - SOUTH SIDE**  
New Bridge for Gerald Grondin  
(GEOGRAPHIC TOWNSHIP OF COLCHESTER NORTH)  
IN THE  
**TOWN OF ESSEX**  
IN THE  
**COUNTY OF ESSEX • ONTARIO**



**ROOD**  
**ENGINEERING**  
**INC.**  
CONSULTING ENGINEERS  
Leamington, Ontario  
519-322-1621

FILE No.:  
**2020D010**  
DRAWN BY: K.D.  
PLOT CODE: 1:1  
FILE: REI2020D010.DWG

DATE: 2020-09-24  
APPENDIX 'E'  
**1 OF 1**  
Page 76 of 76